

(19) World Intellectual Property Organization
International Bureau



(43) International Publication Date
14 March 2002 (14.03.2002)

PCT

(10) International Publication Number
WO 02/19915 A1

- (51) International Patent Classification⁷: A61B 17/00, 17/068, 17/064
- (74) Agents: BROPHY, David et al.; F.R. Kelly & Co., 27 Clyde Road, Ballsbridge, Dublin 4 (IE).
- (21) International Application Number: PCT/IE01/00115
- (81) Designated States (national): AE, AG, AL, AM, AT, AU, AZ, BA, BB, BG, BR, BY, BZ, CA, CH, CN, CO, CR, CU, CZ, DE, DK, DM, DZ, EE, ES, FI, GB, GD, GE, GH, GM, HR, HU, ID, IL, IN, IS, JP, KE, KG, KP, KR, KZ, LC, LK, LR, LS, LT, LU, LV, MA, MD, MG, MK, MN, MW, MX, MZ, NO, NZ, PL, PT, RO, RU, SD, SE, SG, SI, SK, SL, TJ, TM, TR, TT, TZ, UA, UG, US, UZ, VN, YU, ZA, ZW.
- (22) International Filing Date: 7 September 2001 (07.09.2001)
- (25) Filing Language: English
- (26) Publication Language: English
- (30) Priority Data:
S2000/0722 8 September 2000 (08.09.2000) IE
S2000/0724 8 September 2000 (08.09.2000) IE
- (71) Applicants and
(72) Inventors: COLEMAN, James, E. [IE/IE]; 20 Greenmount Road, Terenure, Dublin 6 (IE). CUMMINS, Christy [IE/IE]; 54 Knockowen, Tullamore, County Offaly (IE). MARTIN, Chris [AU/IE]; 2 Blackburn Square, Rathfarnham, Dublin 14 (IE). ANTHONY, Thomas [IE/IE]; 49 Grange Downs, Rathfarnham, Dublin 14 (IE). MORRIS, Sean [IE/IE]; Newpark, Kiltoom, Athlone, County Roscommon (IE).
- (84) Designated States (regional): ARIPO patent (GH, GM, KE, LS, MW, MZ, SD, SL, SZ, TZ, UG, ZW), Eurasian patent (AM, AZ, BY, KG, KZ, MD, RU, TJ, TM), European patent (AT, BE, CH, CY, DE, DK, ES, FI, FR, GB, GR, IE, IT, LU, MC, NL, PT, SE, TR), OAPI patent (BF, BJ, CF, CG, CI, CM, GA, GN, GQ, GW, ML, MR, NE, SN, TD, TG).
- Declarations under Rule 4.17:**
— as to applicant's entitlement to apply for and be granted a patent (Rule 4.17(ii)) for all designations
— of inventorship (Rule 4.17(iv)) for US only
- Published:**
— with international search report

[Continued on next page]

(54) Title: DEVICE FOR LOCATING A PUNCTURE HOLE IN A LIQUID-CARRYING VESSEL

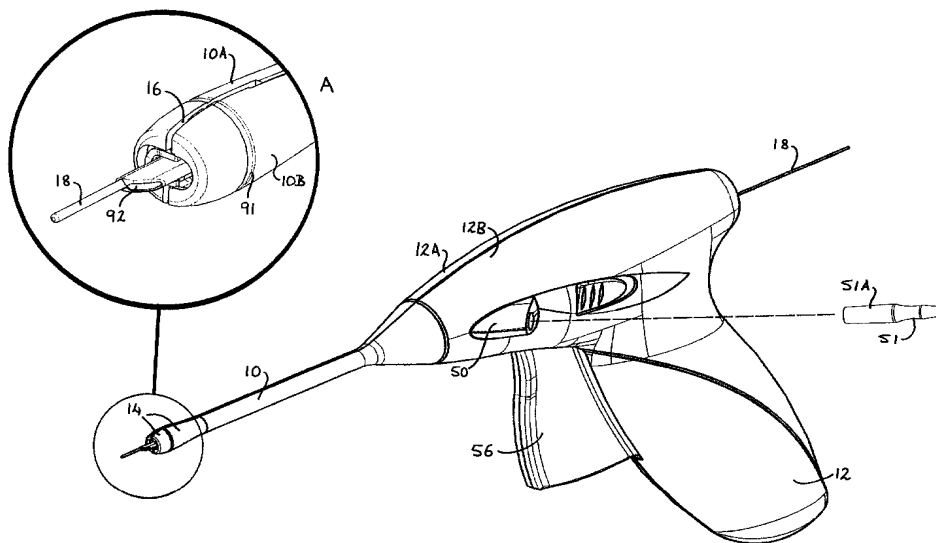

(57) Abstract: A device for locating a puncture hole in a liquid-carrying vessel such as a blood vessel comprises a hollow tube (92) having front and rear openings respectively at opposite ends of the tube to allow the tube to slide along a guidewire passing through the tube. The front opening (96) comprises a first portion (96A) for slidably accommodating the guidewire and a second portion (96B) to allow liquid from the vessel to flow back through the tube. The device is configured, e.g. by a constriction 96C, such that a guidewire at least above a certain diameter in the first portion (96A) of the front opening is restrained against moving into the second portion (96B). Alternatively, the first and second portions (96A), (96B) of the front opening may be independent of one another.



WO 02/19915 A1



For two-letter codes and other abbreviations, refer to the "Guidance Notes on Codes and Abbreviations" appearing at the beginning of each regular issue of the PCT Gazette.

DEVICE FOR LOCATING A PUNCTURE HOLE IN A LIQUID-CARRYING VESSEL

Field of the Invention

5

The present invention relates to a device for locating a puncture hole in a liquid-carrying vessel in a human or animal body. In particular it relates to device for locating puncture holes in blood vessels. Such devices can be used to accurately position a stapling mechanism at the puncture site in a blood vessel after a catheterisation procedure.

10

Background to the Invention

15

When performing catheterisation procedures, such as angiography or angioplasty, a catheter is generally introduced into the vascular system by first penetrating the skin, underlying tissues and blood vessel with a sharpened hollow needle. Next, a guidewire is commonly inserted through the lumen of the hollow needle and is caused to enter the selected blood vessel. Subsequently the needle is typically stripped off the guidewire and a combination of a dilator and/or introducer (or an introducer alone) are fed over the guidewire and pushed through the skin to enter the blood vessel. The guidewire can then be removed and a desired catheter to carry out the procedure is fed through the lumen of the introducer and advanced through the vascular system until the working end of the catheter is appropriately positioned. Following the conclusion of the catheterisation procedure the working catheter will be withdrawn and subsequently the

20

25

30

dilator and/or introducer will also be removed from the wound. Following this procedure the vessel puncture must be closed in order to prevent loss of blood through the puncture hole.

5

Typically the wound is closed by maintaining external pressure over the vessel until the puncture naturally seals. This procedure can take approximately 30 minutes with the length of time usually being greater
10 if the patient is hypertensive or anticoagulated. The procedure can also be uncomfortable for the patient and involves costly professional time on the part of the hospital staff. Other pressure techniques such as pressure bandages, sandbags or clamps have been
15 employed but these also involve ensuring the patient remains motionless for an extended period of time and is monitored to ensure the effectiveness of the procedure.

20 WO 98/17179 discloses a surgical stapler having a blood locator tube adjacent the stapling head. A guidewire passes through an opening at the end of the tube and up through a hollow bore in the tube, so that the stapler can be fed onto the guidewire and down onto the
25 puncture site. When the device reaches the puncture site, the tip of the tube enters the blood flow within the artery and blood passes through the tube and out of the distal end at a point visible to the clinician. The clinician can then actuate the stapling mechanism
30 in the knowledge that the stapling head is at the puncture site in the arterial wall.

The invention aims to provide an improved form of device for locating a puncture site in a liquid-carrying vessel such as a blood vessel.

5 Summary of the Invention

According to the present invention there is provided a device for locating a puncture hole in a liquid-carrying vessel in a human or animal body, the device
10 comprising a hollow tube having front and rear openings respectively at opposite front and rear ends of the tube to allow the tube to slide along a guidewire passing through the tube, wherein the front opening comprises a first portion for slidably accommodating
15 the guidewire and at least one second portion to allow liquid from the vessel to flow back through the tube, the device being configured such that a guidewire at least above a certain diameter in the first portion of the front opening is restrained against moving into the
20 second portion.

In a further aspect the invention also provides a surgical stapler comprising a stapling mechanism located on an end of a shaft and a device adjacent the
25 stapling mechanism for locating the end of the shaft at a puncture site in a liquid-carrying vessel in a human or animal body, wherein the device comprises a hollow tube having front and rear openings respectively at opposite front and rear ends of the tube to allow the
30 tube to slide along a guidewire passing through the tube, wherein the front opening comprises a first portion for slidably accommodating the guidewire and at least one second portion to allow liquid from the

vessel to flow back through the tube, the device being configured such that a guidewire at least above a certain diameter in the first portion of the front opening is restrained against moving into the second
5 portion.

In a still further aspect the invention provides a method of stapling closed a puncture site in a liquid-carrying vessel in a human or animal body, comprising
10 the steps of:

introducing a stapling mechanism to the location of the vessel;

positioning the stapling mechanism at the puncture site by means of a locator device associated with the
15 stapling mechanism, the locator device sensing the position of the puncture site by entering the vessel at the site; and

delivering a staple to, and deforming the staple to close, the puncture site;

20 wherein the locator device comprises a hollow tube having front and rear openings respectively at opposite front and rear ends of the tube to allow the tube to slide along a guidewire passing through the tube, wherein the front opening comprises a first portion for
25 slidably accommodating the guidewire and at least one second portion to allow liquid from the vessel to flow back through the tube, the device being configured such that a guidewire at least above a certain diameter in the first portion of the front opening is restrained
30 against moving into the second portion.

Brief Description of the Drawings

An embodiment of the invention will now be described, by way of example, with reference to the accompanying drawings, in which:

5 Fig. 1 is a perspective view of a surgical stapler including an embodiment of a locating device according to the invention;

10 Fig. 1(A) is an enlarged perspective view of the free end of the shaft of the stapler of Fig. 1;

Fig. 2 is a perspective view of the stapler of Fig. 1 with the left-hand side handle removed;

15 Fig. 3 is a perspective view of the stapler of Fig. 1 with the right hand side handle and shaft removed;

20 Fig. 4 is an exploded perspective view of the components seen in Fig. 3 further omitting the left-hand side handle;

Fig. 5 is an exploded perspective view of the internal components at the free end of the shaft;

25 Fig. 6 is a perspective view of the internal components at the free end of the shaft in the pre-fire position and omitting the left-hand side of the shaft;

30 Fig. 7 is a side elevation of the components of Fig. 6 in the pre-fire position;

Fig. 8 is a front elevation of the components of Fig. 6 in the pre-fire position;

Fig. 9 is a perspective view of the internal components of the free end, showing the position of the components in mid-cycle with fully formed staple;

5

Fig. 10 is a side elevation of the components of Fig. 9 in the post-fire position;

Fig. 11 is a perspective view of the blood locator tube with enlarged views of the front and rear portions, Fig. 11A and Fig. 11B respectively;

10

Fig. 12 is a side sectional elevation of the front portion of an alternative embodiment of the blood locator tube of the stapler;

15

Fig. 13 is a perspective view of the front portion of the blood locator tube shown in Fig. 12;

Fig 13(A) is a perspective view of the front portion of an alternative embodiment of the blood locator tube shown in Fig. 12;

20

Fig. 14(A) is a perspective view of the surgical staple in the pre-fire (pre-deformed) state;

25

Fig. 14(B) is a perspective view of the surgical staple in the post-fire (deformed) state;

Fig. 15 is an enlarged perspective view of the cam mechanism;

30

Fig. 16 is a side elevation of the cam mechanism;

Fig. 17 is a side elevation of the shaft section of the device and suction port; and

- 5 Fig. 18 is an end view of the surgical staple, locator tube and insert.

Detailed Description of the Preferred Embodiments

10 Referring to the drawings, the stapler comprises a rigid shaft 10 extending from a moulded plastic housing 12 shaped in the form of a pistol-like handle. The shaft 10, which is hollow to accommodate various moving components to be described, comprises right and left-
15 hand sides 10A, 10B respectively which are secured together at the distal free end by a section of heat shrinkable tubing 91 in combination with interference pins and mating cavities 15A and 15B (Figs. 4 and 5) along the edges of the distal tip, and at the proximal
20 end by pins 17A mating in an interference fit with corresponding cavities 17B (Fig. 2 and 3) captured within the housing 12. Likewise, the housing 12 comprises left and right-hand sides 12A, 12B respectively.

25

The major part of the exposed length of the shaft 10 has a constant circular cross-section, but at its free end the shaft 10 has a portion 14 of increased diameter having a "bullet" profile. One end of this bullet
30 portion 14 is tapered down toward a staple exit slot 16 while the other end is tapered down to the remaining section of the shaft, which extends back into the housing 12. The ratio of the maximum diameter of the

bullet portion 14 to the diameter of the remaining section of exposed shaft is approximately 5:4. Heat shrink sleeve 91 sits flush with the surface of the bullet portion 14, to ensure atraumatic entry, 5 percutaneously, into the tissue.

The reason for the bullet profile is so that the shaft 10 is as atraumatic as possible during introduction to the body to minimise the amount of force and tissue 10 dilation required when tracking the device percutaneously over a guidewire 18 and onto the surface of a blood vessel adjacent a puncture hole, as will be described. In an alternative embodiment, not shown, the bullet portion 14 is oval in cross-section with the 15 major axis of the oval being coincident with the staple exit slot 16, so as to minimise the circumferential length for a given staple width.

The bullet portion 14 of the shaft 10 houses a staple 20 40 and a staple delivery mechanism (Figs. 4 to 7). The staple delivery mechanism comprises a tiltable anvil 24 and a pair of rod-like actuating members, namely an elongated anvil support 30 and an elongated staple former 52, the latter being slidable in the shaft 10 25 and operated by a trigger-operated cam mechanism 62 in the handle housing 12.

The anvil 24 has a pair of upstanding fingers 24A at the front and a pair of downwardly inclined tilt arms 30 24B at the rear. The anvil 24 is tiltably mounted in the bullet portion 14 by a pair of wings 26 which are pivotable in recesses 28 in the right-hand side 10A of

the shaft 10 (the wings 26 are retained in the recesses by the underside of projections 54 on the former 52).

Tilting of the anvil 24 is effected by the cam
5 mechanism 62 via the anvil support 30, which is
slidable axially within the right-hand shaft side 10A
in channel 32. The front end of the anvil support 30
is bifurcated to form two arms 34 having lateral
10 projections 36 (Figs. 6 and 7). The arms slide in
rebates 38 in the right-hand shaft side 10A. The anvil
support 30 is movable, by the cam mechanism 62, from a
forward position, Figs. 6 and 7, wherein the arms 34
extend under the anvil's support wings 25 to support
the anvil forming fingers 24A directly in front of a
15 surgical staple 40 to be delivered, to a rearward
position, Fig. 10, wherein the arms 34 are withdrawn
under the downwardly inclined tilt arms 24B at the rear
of the anvil 24 so as to tilt the anvil anti-clockwise
(as seen in Fig. 10) and displace the fingers 24A out
20 of the path of the staple 40. The angle of incline of
tilt arms 24B may be increased to cause separation of
the two shaft halves, in addition to displacing the
fingers 24A out of the path of the formed staple, to
aid in staple release. This is achieved by the anvil
25 (in its fully tilted position) applying pressure to the
underside of former 52 and the upper surface of the
right shaft 10A.

30 Referring additionally to Figs. 11, 11A and 11B, a
hollow blood locator tube 92 is slidable axially within
the shaft 10 in a channel 44 in the anvil support 30
and in an opposing U-shaped channel 53 in the staple

former 52. The tube 92 extends the full length of the shaft 10 and has a constant, generally oval or elongated cross-section, except at its distal tip 14 where the locator tube 92 is formed into a narrow opening 96 and at a crimped region 94 towards the rear of the tube 92 which is formed to allow only the guidewire 18 and not blood to exit the rear of the locator tube.

Under the action of the cam mechanism 62 the tube 92 is slidable axially in the shaft 10 between a forward position, Figs. 6 and 7, wherein its front end projects beyond the bullet portion 14 of the shaft 10 under the influence of a leaf spring 88 to be described, and a rearward position, Figs. 9 and 10, wherein the front end of the tube 92 is retracted within the bullet portion 14 behind the fingers 24A of the anvil 24 during the rotation of cam 62.

The purpose of the blood locator tube 92 is to follow a previously placed guidewire 18 to a puncture site in a blood vessel, thereby to locate the free end of bullet portion 14 of the shaft 10 against the exterior wall of the blood vessel at the puncture site. To properly locate the bullet portion 14 the front end of the tube 92 must actually penetrate the blood vessel wall at the puncture site and this is indicated by blood flowing back through the tube 92 and out through a blood outlet port 93 (Fig. 11) in the tube. A channel (not shown) in the part of the left-hand side 10B of the shaft 10 within the housing 12 provides communication between the port 93 and a blood exit port 50 (Fig. 1) on the side of the housing 12B, so that the blood flowing back

through the tube 92 is visible at the exterior of the housing.

A blood exit port adapter 51 (Fig. 1) may be secured
5 into the opening of the blood exit port 50 via a
matching male luer taper 51A to enhance the visibility
of the exiting blood. The blood exit port adapter has
a reduced internal diameter, relative to the opening of
the blood exit port 50, which for a constant blood flow
10 increases the pressure of exiting blood causing a jet
effect of exiting blood.

In the absence of the blood exit port adapter, the
blood exit port's female luer taper opening matches
15 that of the standard medical syringe's male luer taper
making it possible at any time during the device's use
to inject fluid via the blood exit port into the lumen
of the locator tube to exit at its distal tip. This
may be necessary from time to time to clear the locator
20 tube's lumen of congealed blood and of trapped soft
tissue. Alternatively, radiopaque contrast medium may
be injected via the locator tube to confirm the
relative location of the locator tube's distal tip to
that of the blood vessel wall by fluoroscopy, or any
25 injectable fluids may be injected for diagnostic or
therapeutic reasons.

The blood outlet port 93 is sized to have a minimum
area corresponding to the available blood entry area at
30 the distal tip; however, is narrower (in a transverse
aspect) than the diameter of the guidewire 18 to
prevent the guidewire inadvertently exiting the blood

outlet port during insertion, instead of exiting from the intended proximal end of the locator tube.

5 It has been found that the naturally formed shape of
puncture wounds in arterial walls is elongated rather
than round. Whereas the hole is formed by introducing
instruments generally of round cross section, the wall
tends to open generally along a transverse line which
10 lies in the direction of the circumference of the
artery (rather than along the axis of the artery). By
having a generally oval blood locator tube, the locator
tube (when introduced by the clinician with the major
axis of the oval perpendicular to the axis of the
15 artery), will fit more naturally within the arterial
opening. The consequence of this is that the wound
edges which are to be stapled together, lie closer
together than if a tube of circular cross section were
to be used.

20 This in turn has the consequence that the staple used
need not be so large, and in turn, the dimensions of
the shaft, which must accommodate the staple when in
its unformed state, can be reduced, leading to less
trauma for the tissue into and from which the shaft is
25 introduced.

A further consequence of having a generally oval or
elongated cross section for the locator tube is that
the tube will be more disposed to the centre of the
30 puncture than with a rounded tube. The present
embodiment has a staple which straddles the locator
tube, thereby increasing the likelihood of the staple

closing the elongated wound at its centre rather than towards one or other of the extremities of the wound.

The opening 96 at the front of the tube 92 has an
5 approximately circular portion 96A at the extreme
forward tip of the tube which is of greater diameter
than the width of the remaining portion 96B of the
opening 96. The portion 96B is in the form of a slot
10 which is aligned with the major axis of the elongated
cross-section of the tube 92 and slopes rearwardly from
the circular portion 96A. The guidewire 18, which
passes through the tube 92, Fig. 11, is chosen to be of
sufficiently smaller diameter than the diameter of the
opening 96A at the front end of the tube 92 for the
15 guidewire 18 to be easily inserted into the tube 92 and
pass through the opening 96A. However, the guidewire
is also chosen to be too large to fit within the
remainder 96B of the opening 96. In this way guidewire
18 is constrained to remain in opening 96A, and the
20 size of opening 96A sets an upper limit on the diameter
of guidewire which can be used with the device. One
could introduce a narrow neck or constriction into the
opening 96 just above opening 96A (at the points
indicated by 96C) to ensure that very small guidewires
25 were constrained within the enlarged opening 96A, but
in general this is unnecessary as the guidewire will
normally be supplied with the device, or the device
will only be supplied for use with a particular gauge
of guidewire.

30

The rear crimp 94 and tip opening 96A are positioned to encourage the guidewire to lie along the bottom curved surface of the tube, i.e. that portion of the tube

lying in a direct line between the opening in the crimped end and the opening 96A. This helps prevent guidewire 18 from laying up against the inside of blood exit port 93 and preventing egress of blood, Fig. 11A and 11B.

The curvilinear nature of opening 96 increases the available inlet area to match that of the available area within the body of the locator tube with the guidewire 18 in situ.

The slot-like opening 96B slopes away from the circular opening 96A for ease of insertion into the vessel opening and to reduce the potential of trauma to the inner wall of the vessel opposite the opening being stapled. This is achieved because the guidewire 18 protruding from opening 96A will tend to push the opposite wall of the vessel away from the locator tube tip, and the point at which the guidewire protrudes (due to it being constrained in the opening 96A) is the farthest part forward of the tip. Thus, the shape of the tip is streamlined away from opening 96A to prevent any part of the tip gouging into or otherwise damaging the inner vessel walls. Also, the peripheral edges 95 of the opening 96 are bent inwardly to avoid sharp edges which might damage soft tissue and the vessel wall.

The distal end of an alternative embodiment of a locator tube 42 is shown in Figs. 12 and 13. This embodiment also has a substantially constant elongated cross-section, which in this case converges to an approximately circular guidewire opening 46 at the

extreme forward tip of the tube. The guidewire 18, which passes through the tube 42, is usually chosen to be of sufficiently smaller diameter than the diameter of the opening 46 for there to be an adequate gap for the blood to pass back through the tube 42 even in the presence of the guidewire. However, further openings 46A are provided in opposite sides of the tube 42 just behind the front opening 46 to allow more ready access of the blood to the interior of the tube in cases where the guidewire 18 may not leave a large enough gap for passage of blood solely through the opening 46. The three openings 46, 46A, 46A in fact form respective portions of a single front opening, being in reality three connected lobes, all connected by constricted channels 47, and all in communication with the interior of the tube.

An alternative embodiment is shown in Fig. 13(A) where the three openings 46, 46A and 46A, while collectively constituting the front opening of the tube 42, are independent of each other. Again, opening 46 at the front of the tube is sized to receive a maximum size of guidewire and openings 46A are sized to allow a sufficient flow of blood to enter the locator tube.

A problem can arise in devices of this type where an oversized guidewire is used which occludes the hollow interior of the blood locator tube and thereby prevents blood flow back through the tube. To prevent this situation the lobe 46 through which the guidewire emerges in the tip of the tube of Figs. 12, 13 and 13A is of a lesser diameter than the internal bore of the tube. The dimensions of this lobe 46 set a maximum for

the guidewire diameter for use with the device, and ensure that even when this maximum diameter guidewire is used, there is still sufficient internal clearance within the tube bore to allow a strong blood flow
5 through the tube from the other lobes 46A.

The staple 40 straddles the blood locator tube 92 within the bullet portion 14 of the shaft 10, see Figs. 6 and 8, and is slidable thereon forwardly towards the
10 free end of the bullet portion 14. In particular (see also the enlarged view of Fig. 14), the staple 40 comprises a back or base portion 40A from which extend perpendicularly at each end respective legs 40B which terminate in sharpened points. The base portion 40A
15 and legs 40B lie in substantially a common plane except for a centre portion 40C of the base portion 40A which is deformed in a direction perpendicular to the legs 40B so as to have an Ω (omega) shape generally complementary to the external cross-sectional profile
20 of the blood locator tube 92 and internal cross-section of an insert 160, to be described. The base section 40A is pre-bent to between 150° and 170° at points A and B equidistant from the centre of the base, positioned to maximise the closure of the closed staple
25 (and is relevant to the depth of forming wings 54 on the former 52). The base section is also deformed at points C & D so as to narrow the cross sectional width of the wire at both points thereby directing the staple to bend at these points. The staple 40 is mounted on
30 the blood locator tube 92 such that the centre portion 40C of the staple sits on the upper half of the tube 92, as seen in Fig. 6 and 8, where the narrow open section of the omega shape is approximately equal to

the width of the tube and with the legs 40B pointing forwardly on opposite sides of the tube 92. The depth of the centre portion 40C of the staple 40 is such that the legs 40B of the staple lie substantially directly on opposite sides of the central axis of the tube 92. This will ensure that the staple 40 is positioned centrally across the puncture hole in the blood vessel. In order to avoid the guidewire 18 fouling the staple 40 when the latter is closed on the puncture site, the hole 96A is offset below the plane containing the legs 40B of the staple, Fig. 8.

The metal insert 160 is received in a recess in the left-hand shaft side 10B within the bullet section 14. The insert 160 provides mechanical support for the omega section 40C of the staple 40 during the staple forming process and is engaged by the former 52 during the staple ejection phase of the process so as to separate both halves of the bullet section for easy staple release. The insert is profiled to generally correspond with the external profile of the omega shaped portion 40C of the staple. At the distal end the insert profile tapers down to closely approximate the omega-shaped portion of the staple 40C (Fig. 18). This has the effect of offering mechanical support to the omega-shaped portion of the staple during the staple forming process, during which the base section is bent about the anvil fingers. This bending motion in turn causes the omega to open up or flatten out. The metal insert prevents this from happening only allowing the staple base to deform around the anvil. The omega interlock system between the staple 40 and insert 160 (Fig. 18) also stabilises the staple,

vertically, within the staple exit plain during the forming process, whilst allowing easy staple release once formed, due to the relatively small contact area between staple and insert.

5

The staple former 52 has a cross-section conforming to that of the blood locator tube 92 and is slidable on the blood locator tube 92 axially within the shaft 10. The former 52 is located behind the staple 40 on the
10 tube 92 and is operated by the cam mechanism 62. At its front end the former 52 has a pair of forming arms 54 which are so shaped that, when the former 52 is driven forward by the cam mechanism 62, the staple 40 is driven against and deformed around the anvil fingers
15 24A so that the legs 40B of the staple close together (Fig. 9) onto the puncture site. The surface of the forming arms which contact the staple 55 may be so profiled to match the cross-sectional geometry of the staple. This matching profile stabilises the staple on
20 the forming surfaces of the forming arms 54 during the high pressure contact with the staple during staple forming and closure. During the forward movement of the staple, the staple legs slide toward the anvil 24 along a track defined by the staple exit slot 16
25 between the opposite halves the bullet portion 14. The slot 16 provides a slight interference fit on the staple legs 40B to prevent the staple 40 moving forward during storage of the device or prior to firing. The slot 16 further prevents the staple rotating in the
30 horizontal plane (Fig. 7 and 10) during its forward travel. Once forming of the staple around the anvil is completed the forming force is removed from the former 52 by a drop-off in the cam, the anvil is lowered and

the former advanced again to eject the staple from the device. During this forward movement (ejection phase), the sloped edges 52A and 52B of the former engage with the metal insert 160 to prise open the bullet section
5 of the shaft assembly thus facilitating staple release.

The cam mechanism 62 can be seen in Fig. 3 and in enlarged views of Figs. 15 and 16. The mechanism 62 consists of a first cam 58 and a second cam 60 mounted
10 on a common axis 62 which sits in a recess 64 in the left-hand side 10A of the shaft (Fig. 4) and a corresponding recess (not shown) in the right-hand side 10B. Trigger 56 is similarly mounted in the shaft by a pair of stub axles 66 which are received in a trigger
15 seating recess 68 in each half of the shaft 10, Fig. 4.

An actuating pin 70 extends through the first and second cams 58, 60. This actuating pin is acted on by a cam actuating surface 72 (Fig. 3) provided on the
20 trigger 56, so that when the trigger is squeezed the actuating surface moves the actuating pin in an anticlockwise direction around the axis 62. Because the actuating pin extends through both cams 58, 60 of the mechanism 62, the cams are both rotated
25 simultaneously through the same angle as determined by the trigger squeeze. The use of this cam mechanism ensures accurate timing and positive mechanical displacements of all the moving components and accurate movement of the components relative to each other. The
30 geometry of the trigger pivot pins 66 and actuating surface 72 relative to the cam pivot 62 and cam actuating pin 70 is configured to minimise the trigger rotation to only 23 degrees whilst the cam rotates a

total of 90 degrees. This configuration also provides a mechanical advantage that the trigger delivers to the cam-actuating pin 70 of approximately 1:4. This geometry is further configured to deliver the best
5 mechanical advantage at the phase during the staple forming cycle, which requires the highest forming forces, having the advantage of minimising the trigger effort and ensuring a constant trigger effort over the full cycle. Trigger 56 further comprises a ratchet
10 lever 73B, shown in Fig. 3, which engages with ratchet strip 73A, which is mounted in the right handle 12A, Fig. 3. This non-return ratchet system ensures the firing cycle of the staple is uninterrupted, non-repeatable and provides a positive indication that the
15 device has been used.

Referring back to Fig. 3, a leaf spring 88 positioned in a recess in the left-hand side 10A of the shaft and a corresponding recess (not shown) in the right-hand
20 side 10B. The free ends of the spring are formed into a loop so as to pivot freely in the curved corner recesses in which it sits and to aid assembly. The apex of this spring is positioned in a slot 74 in the crimped portion 94 of the blood locator tube 92 thus
25 assuming the role of cam follower for the blood locator tube. This blood locator tube cam follower 74 is acted on by the first cam 58. Similarly, the first cam 58 acts on a former cam follower 76, whereas the second cam 60 acts on anvil-support cam followers 78A and 78B.
30 The shape of the first and second cams 58, 60 are shown in elevation in Fig. 16 (the second cam 60 is shown in dotted outline as it is concealed by the first cam). Fig. 16 also shows actuating pin 70, and a reinforcing

strut 80 mounted between the first and second cams diametrically opposite the actuating pin 70.

5 The cams are shown in the starting positions in Fig. 15 and 16. Squeezing the trigger fully (through an angle of 23 degrees) causes the cams to rotate anticlockwise through 90 degrees.

10 The apex of the leaf spring 88 which engages with and operates as a cam follower for the blood locator tube (leaf spring apex) acts against the rear surface 82 of the first cam 58. As the first cam rotates anticlockwise from the position shown in Fig. 15, the distance between the blood locator tube cam follower 74
15 and the axis 62 is increased. This causes the blood locator tube to be drawn backwards as the trigger is squeezed.

20 The former cam follower 76 acts against the front surface 84 of the first cam 58. Again the distance between former cam follower 76 and axis 62 increases through the initial stages of the trigger being squeezed. The profile of surface 84 is designed with two distinct non-linear efficiencies, transitioned from
25 low mechanical efficiency/high displacement to high mechanical efficiency/low displacement. The first rise rate being for displacement of the staple from its starting position to initial forming against the anvil, which requires the largest displacement of the staple
30 with minimal load. The second non-linear rise rate is designed to correlate the cams mechanical efficiency with the load profile required to form the closed staple, minimising the trigger effort required and

ensuring a constant trigger effort over the full cycle. A V-shaped section 84A of front section 84 causes the former 52 to momentarily suspend its forward motion when the staple has been fully formed. The effect of this is to momentarily release the pressure off the formed staple against the anvil, allowing the anvil to be dropped. The geometry of the distal tip of the former is designed to provide sufficient intrinsic spring tension to allow the forming arms 54 to further squeeze the formed staple, once the anvil has dropped, to further closed the formed staple. As the cam continues to rotate the raised profile 84B on the cam causes the former to advance forward again, ejecting the staple clear of the device.

It can be seen that a raised hump 82A on the profile of the rear surface 82 of the first cam is located almost diametrically opposite the V-shaped section 84A. The reason for this is to increase the rate at which the blood locator tube is drawn out of the puncture site just before the staple is fully formed and released. The intention is to leave the tube in the puncture as late as possible to provide support for the walls of the blood vessel for as long as possible And also to ensure that the head of the device remains centred over the puncture hole. The blood locator tube 92 is biased forward by the blood locator tube leaf spring 88 which also maintains pressure between the apex of the spring and the rear surface 82 of the first cam 58.

The blood locator tube leaf spring 88 allows the locator tube to be displaced in a proximal direction (back into the shaft of the device) against the spring

tension in the event that the locator tube meets any significant resistance during insertion of the device, to prevent unnecessary trauma to soft tissues, the vessel or its rear wall.

5

An example of where this is particularly useful is if the stapler is advanced too far into the vessel, so that the tip of the tube 92 meets the inner wall. The blood locator tube will then be displaced back into the shaft, and may be designed to protrude through the end of the handle housing to give a visual indication that the device has been inserted against the wall.

10 Furthermore, the device may be designed so that the blood outlet port 93 on the tube 92 is brought out of registry with the blood exit port 50 in the handle housing when the tube is displaced backwards, so that the clinician will note the flow of blood ceasing when the tube meets the inner vessel wall in this way.

15 The cam mechanism 62, however, provides positive mechanical displacements for withdrawing the locator tube at the appropriate timing, to ensure there is no chance of the staple being formed whilst the locator tube is in a forward position and potentially interfering with the staple formation.

20 A further reason to leave the blood locator tube in the puncture hole as late as possible is that the continued retraction of the tube everts or turns outwards the opposed edges of the puncture wound and aids penetration of the staple legs into the arterial wall. Eversion of the edges of the puncture helps prevent thrombus formation within the vessel. Yet another

30

reason to leave the blood locator tube in the puncture hole as late as possible is to ensure that the stapler head remains centred over the hole during the staple delivery process. When the locator tube is fully retracted, only the guidewire is left within the wound, and this will be easily retracted from the closed wound after the stapler has been removed from the puncture site.

10 The anvil-support cam follower 78B acts against the rear surface 90 of the second cam 60. It can be seen that this rear surface 90 provides the greatest increase in distance relative to the axis to the section 90A from about 60 to 90 degrees below the horizontal. The reason for this is that the anvil is maintained in place until the staple has been formed and the pressure on the former has been relaxed slightly to allow the anvil to drop. The anvil is maintained in place for the initial 60 degrees of rotation by the anvil-support cam follower 78A being in contact with cam surface 98 of cam 60, preventing the anvil-support 30 from moving from its starting position. The cam surface 98 for the first 60 degrees of cam rotation is at a constant distance from the cam axle 62 (in dwell).

In use, the stapler is initially in the "pre-fire" configuration shown in Figs. 6 to 8. The front end of the blood locator tube 92 is in a fully forward position projecting beyond the free end of the bullet portion 14 of the shaft 10, the anvil-support 30 is in a fully forward position with its arms 36 extending under the anvil's support wings 25 ensuring the anvil

fingers 24A are directly in front of the staple 40, the former 52 is in a fully retracted position away from the anvil fingers 24A, and the staple 40 is in its fully back position up against the forming arms 54.

5

In this configuration the external end of a previously positioned guidewire 18 is inserted into the hole 96A in the front end of the blood locator tube 92 and fed through the tube 92 until it exits a guidewire exit port at the rear of the housing 12. The stapler is now fed along the guidewire 18 until the tip 95 of the tube 92 enters the blood vessel lumen through the vessel's puncture hole. This is indicated by blood flowing out of the blood exit port 50 or, if present, the adapter 15 51. At this point the front end of the bullet portion 14 of the shaft 10 will be resting against the exterior wall of the blood vessel.

Now the trigger 56 is squeezed, causing the cams of the cam mechanism 62 to rotate through 90 degrees. As 20 mentioned, the rear end of each of the blood locator tube 92, anvil-support 30 and former 52 are coupled to the cam mechanism via cam followers and the following co-ordinated movement of these components takes place 25 as the cams rotate through 90 degrees.

(A).

0 degrees: Stapler in pre-fire configuration.

32 degrees: Former 52 forward sufficiently to clamp 30 staple against anvil fingers 24A, blood locator tube begins to retract. At this point the staple legs will have punctured the wall of blood vessel, but the staple is not yet fully deformed.

50 degrees: Former 52 forward sufficiently to deform the staple legs around the anvil fingers 24A and close the staple on the puncture site: blood locator tube 42 fully retracted. At some point between 32 and 50

5 degrees, the blood locator tube will have withdrawn from between the staple legs in time to allow them to close. This should be left as late as possible to provide support for the walls of the blood vessel for as long as possible.

10 **65 degrees:** Clamp force released from staple (due to drop off in cam profile). Anvil support 30 starting to retract.

75 degrees: Anvil support 30 retracted sufficiently to act against anvil sloped tilt arms 24B. Anvil fingers

15 24A begin to drop.

83 degrees: Anvil support 30 fully retracted. Anvil fingers 24A dropped down to allow release of staple. Intrinsic tension in former arms 54 further closes the staple. Former 52 begins to move forward again to

20 eject staple. Former 52 begins to interfere with the insert 160 to spread bullet portion 14 of the shaft to allow for clear staple release.

90 degrees: Former 52 fully forward; staple ejected from the device.

25

The use of cams in cam mechanism 62 ensures the accuracy of sequence and relative timing between events as well as ensuring positive mechanical displacements of all components.

30

In a further embodiment to the above described device, on the completion of the cycle described above, further rotation of the cam causes the anvil support 30 to

return to its fully forward position, lifting the anvil
fingers 24A to their raised position behind the formed
staple being held in forming arms 54. The former is
then retracted in a proximal direction (back into the
5 shaft) causing the rear of the closed staple to crash
into the raised anvil fingers 24A, to be positively
ejected from within the forming arms 54 and the device.
The additional movements of the anvil support and
former may be facilitated by additional cam lobes on
10 cam 58; or alternatively spring driven, assisted and
timed by appropriately positioned radial slots in cam
58 to allowing the cam follower of the anvil support to
move forward and the cam follower of the former to move
rearwards.

15

In a further embodiment the trigger activates an
automatic firing cycle, not shown. A tension spring
attached to the cams is released from its extended
state so as to rotate the actuation cam through a 90
20 degree arc causing the same component movements as
described above.

In an alternative embodiment, not shown, once the
staple has been formed the forward end of the former 52
25 retracts and engages pull arms on the anvil-support 30
causing it to move in a rearward direction. As it does
so, it engages with the rear end of the anvil 24, which
is angled downward into the path of the moving slide.
Centrally opposed wings extend from the anvil and are
30 located so as to pivot in opposed wing slots formed in
the right-hand side 10A of the shaft. Once engaged
with the slide the rear end of the anvil is pushed
upward causing it to pivot about the wings and arc the

forward end of the anvil downward. As it does so, it disengages from the staple so that the device can be removed from the puncture tract along the guidewire.

5 In a further embodiment the reverse profile 82 on the first cam 58 which engages with the cam follower 74 on the blood locator tube 92 is extended so that when the staple forming cycle is completed the first cam continues to rotate causing the blood locator tube to
10 move further in a proximal direction. At its distal end the blood locator tube has wings which as it moves in a proximal direction engages with the pull arms of the anvil-support 30 causing it to move in a proximal direction and engage the anvil tilt arms thereby
15 disengaging the distal end of the anvil from the formed staple. In this embodiment the second cam is redundant and can be omitted.

In a further embodiment, Fig. 17, the bullet head 14 of
20 the shaft 10, which approximates the blood vessel wall 208, includes a number of suction ports 200. These ports are in communication with a suction adapter 202 via capillaries 204 within the shaft section. Suction,
25 from a standard wall suction outlet or independent suction pump, is supplied to the suction adapter 202 via an on/off tap 206. Once the device is in position on the arterial wall, as indicated by blood flowing from the blood exit port, the tap 206 is turned to the
30 "on" position thereby delivering suction to the ports 200 on the bullet head 14. This in turn suctions the blood vessel wall 208 against the face of the head 14 so as to stabilise it during delivery of the staple. Once delivered the suction is deactivated so as to

remove the device from the blood vessel wall and tissue tract.

The invention is not limited to the embodiments
5 described herein and may be modified or varied without
departing from the scope of the invention.

Claims

1. A device for locating a puncture hole in a liquid-carrying vessel in a human or animal body, the device
5 comprising a hollow tube having front and rear openings respectively at opposite front and rear ends of the tube to allow the tube to slide along a guidewire passing through the tube, wherein the front opening comprises a first portion for slidably accommodating
10 the guidewire and at least one second portion to allow liquid from the vessel to flow back through the tube, the device being configured such that a guidewire at least above a certain diameter in the first portion of the front opening is restrained against moving into the
15 second portion.

2. A device as claimed in claim 1, wherein the first and second portions of the front opening are independent of one another.
20

3. A device as claimed in claim 1, wherein the first and second portions of the front opening communicate with one another.

25 4. A device as claimed in claim 1, 2 or 3, wherein the first portion of the front opening is at least approximately circular and is disposed at the extreme forward tip of the tube, wherein the tube converges to the said forward tip, and wherein the second portion of
30 the front opening is disposed in the sidewall of the tube behind the tip.

5. A device as claimed in claim 4, wherein the first and second portions of the front opening communicate via a constriction.

5 6. A device as claimed in any one of claims 1 to 3, wherein the first portion of the front opening is disposed at the extreme forward tip of the tube and the second portion slopes rearwardly from the first portion.

10

7. A device as claimed in claim 6, wherein the first portion of the front opening is at least approximately circular and the second portion of the front opening is a slot.

15

8. A device as claimed in claim 7, wherein the width of the slot is less than the diameter of the first portion.

20 9. A device as claimed in claim 7 or 8, wherein the circular first portion of the front opening communicates with the slot via a constriction.

10. A device as claimed in any preceding claim, wherein at least adjacent its front end the tube has a generally elongated cross-section.

11. A device as claimed in claim 10 when dependent on claim 7, wherein the slot is aligned with the major axis of the elongated cross-section of the tube.

30

12. A device as claimed in claim 4 or 5, wherein the front opening has two second portions disposed respectively on opposite sides of the tube.

5 13. A surgical stapler comprising a stapling mechanism located on an end of a shaft and a device adjacent the stapling mechanism for locating the end of the shaft at a puncture site in a liquid-carrying vessel in a human or animal body, wherein the device comprises a hollow
10 tube having front and rear openings respectively at opposite front and rear ends of the tube to allow the tube to slide along a guidewire passing through the tube, wherein the front opening comprises a first portion for slidably accommodating the guidewire and at
15 least one second portion to allow liquid from the vessel to flow back through the tube, the device being configured such that a guidewire at least above a certain diameter in the first portion of the front opening is restrained against moving into the second
20 portion.

14. A method of stapling closed a puncture site in a liquid-carrying vessel in a human or animal body, comprising the steps of:

25 introducing a stapling mechanism to the location of the vessel;
 positioning the stapling mechanism at the puncture site by means of a locator device associated with the stapling mechanism, the locator device sensing the
30 position of the puncture site by entering the vessel at the site; and
 delivering a staple to, and deforming the staple to close, the puncture site;

wherein the locator device comprises a hollow tube having front and rear openings respectively at opposite front and rear ends of the tube to allow the tube to slide along a guidewire passing through the tube,

5 wherein the front opening comprises a first portion for slidably accommodating the guidewire and at least one second portion to allow liquid from the vessel to flow back through the tube, the device being configured such that a guidewire at least above a certain diameter in

10 the first portion of the front opening is restrained against moving into the second portion.

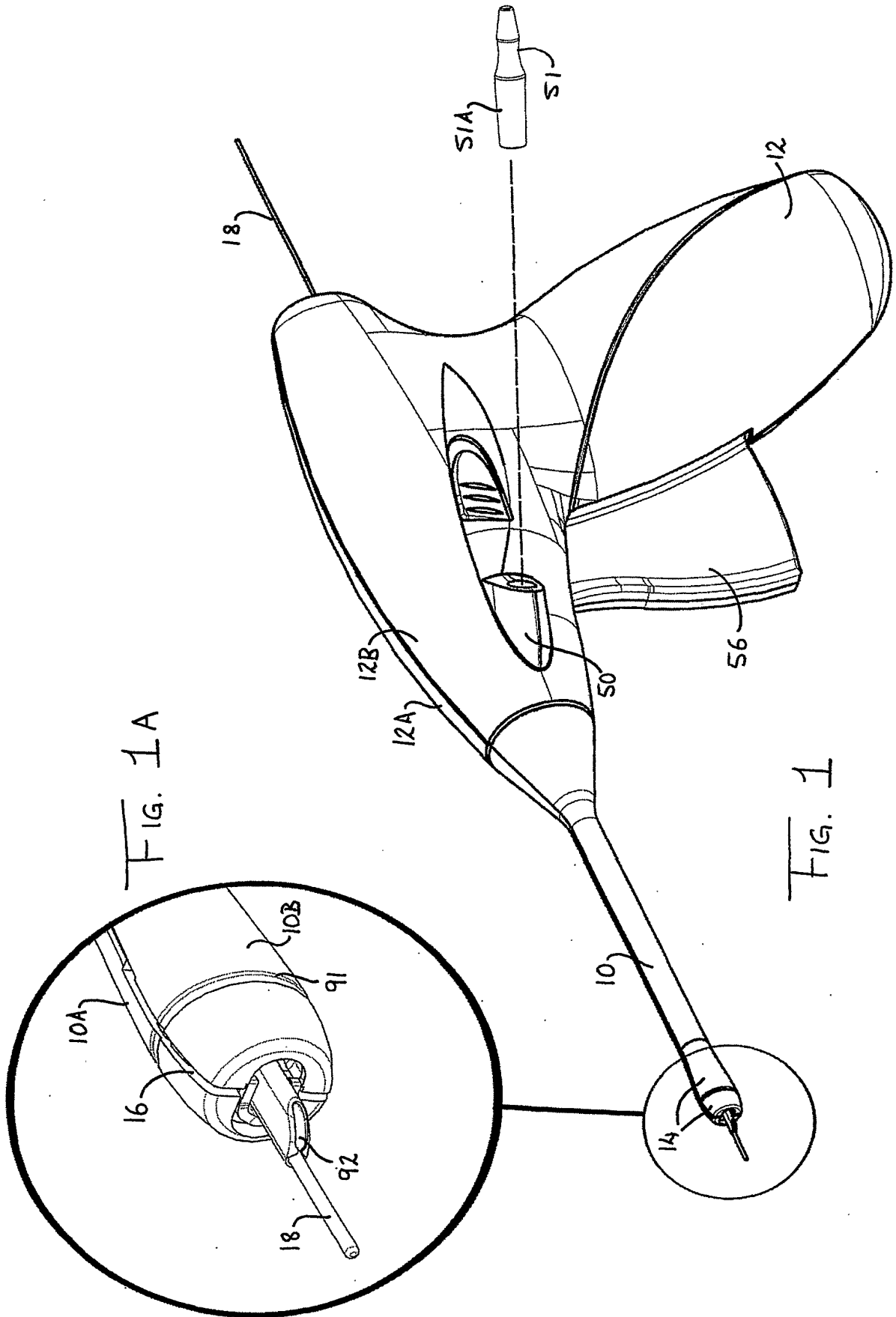

FIG. 1A

FIG. 1

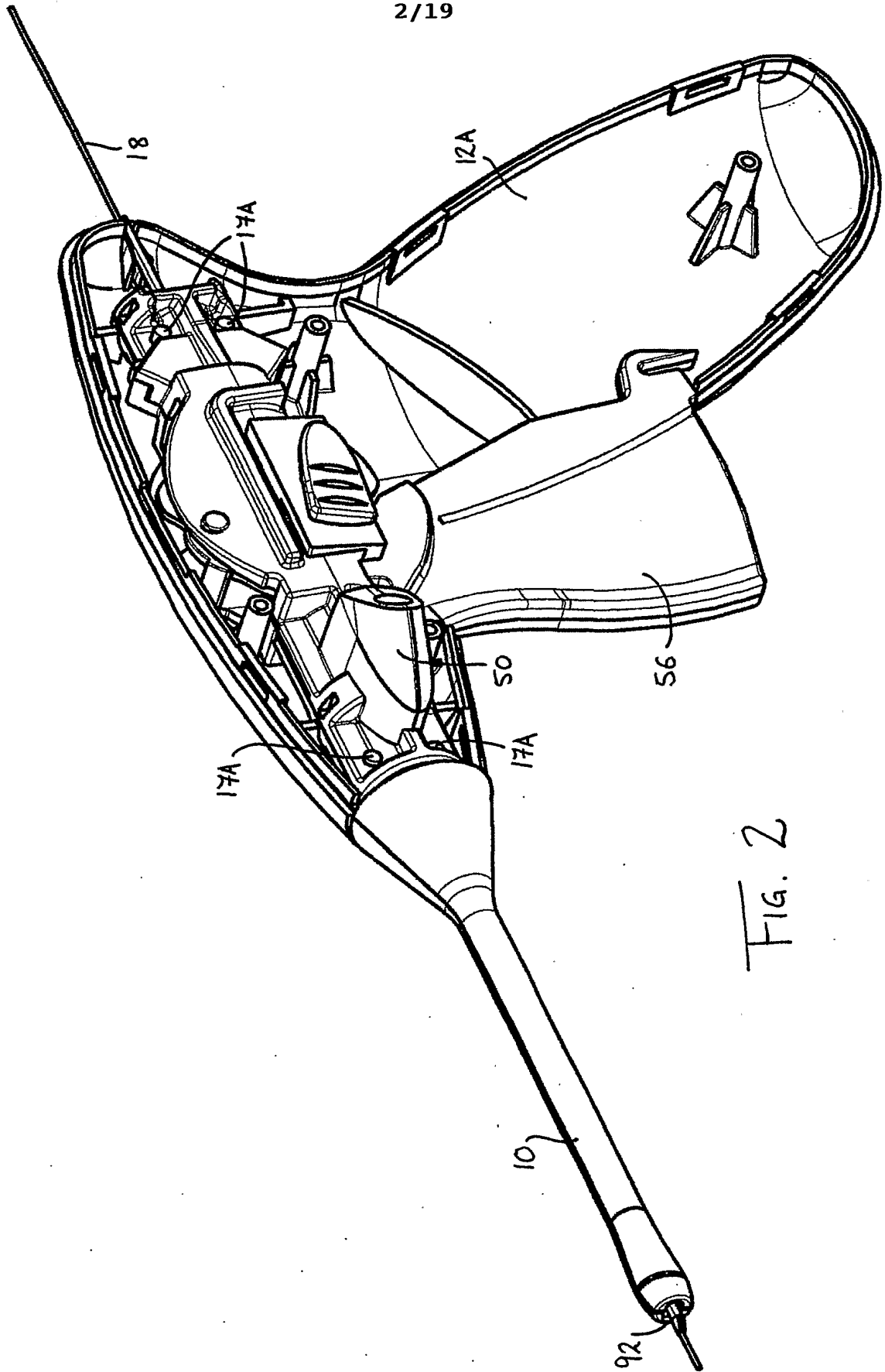

FIG. 2

3/19

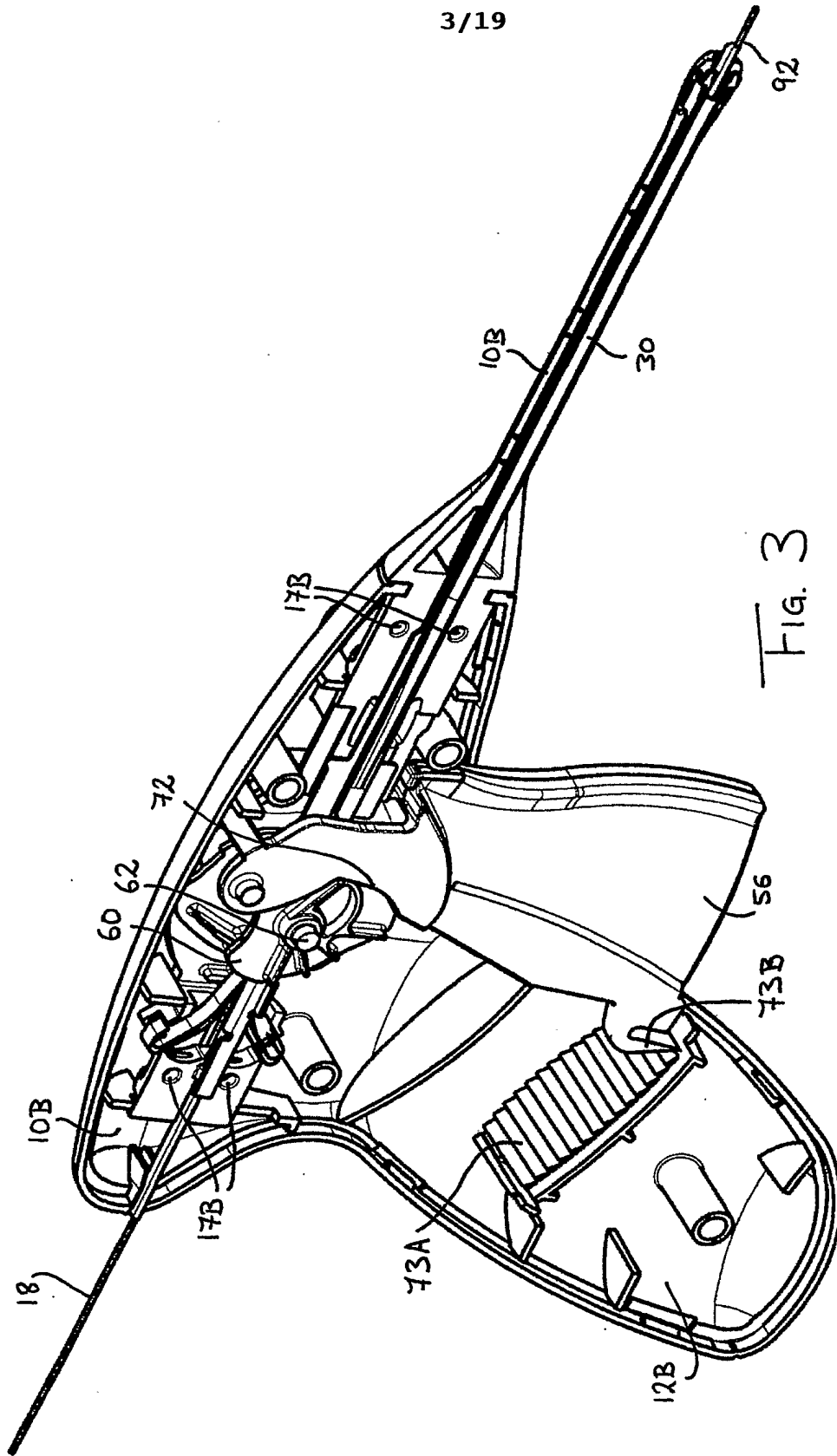
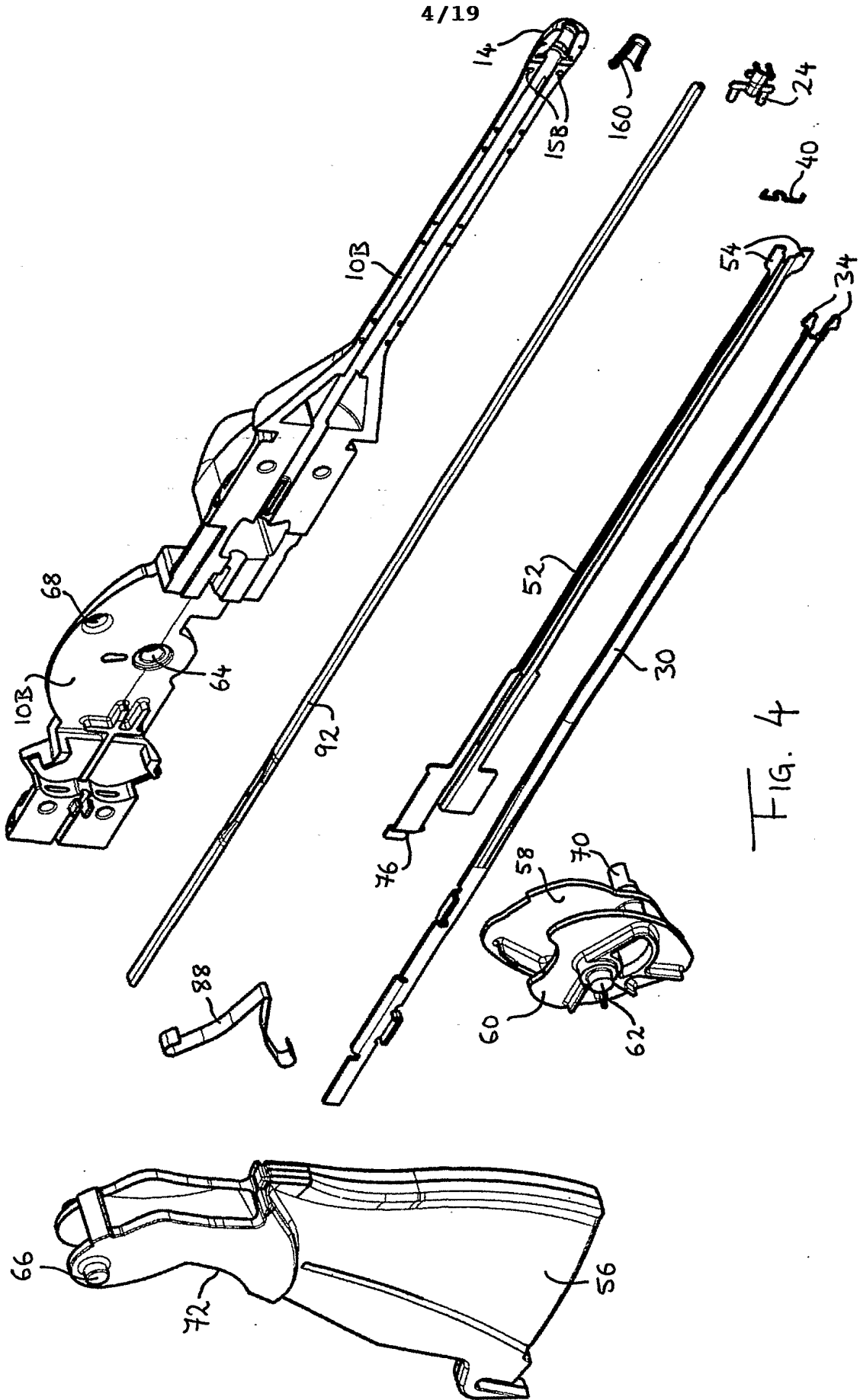

FIG. 3



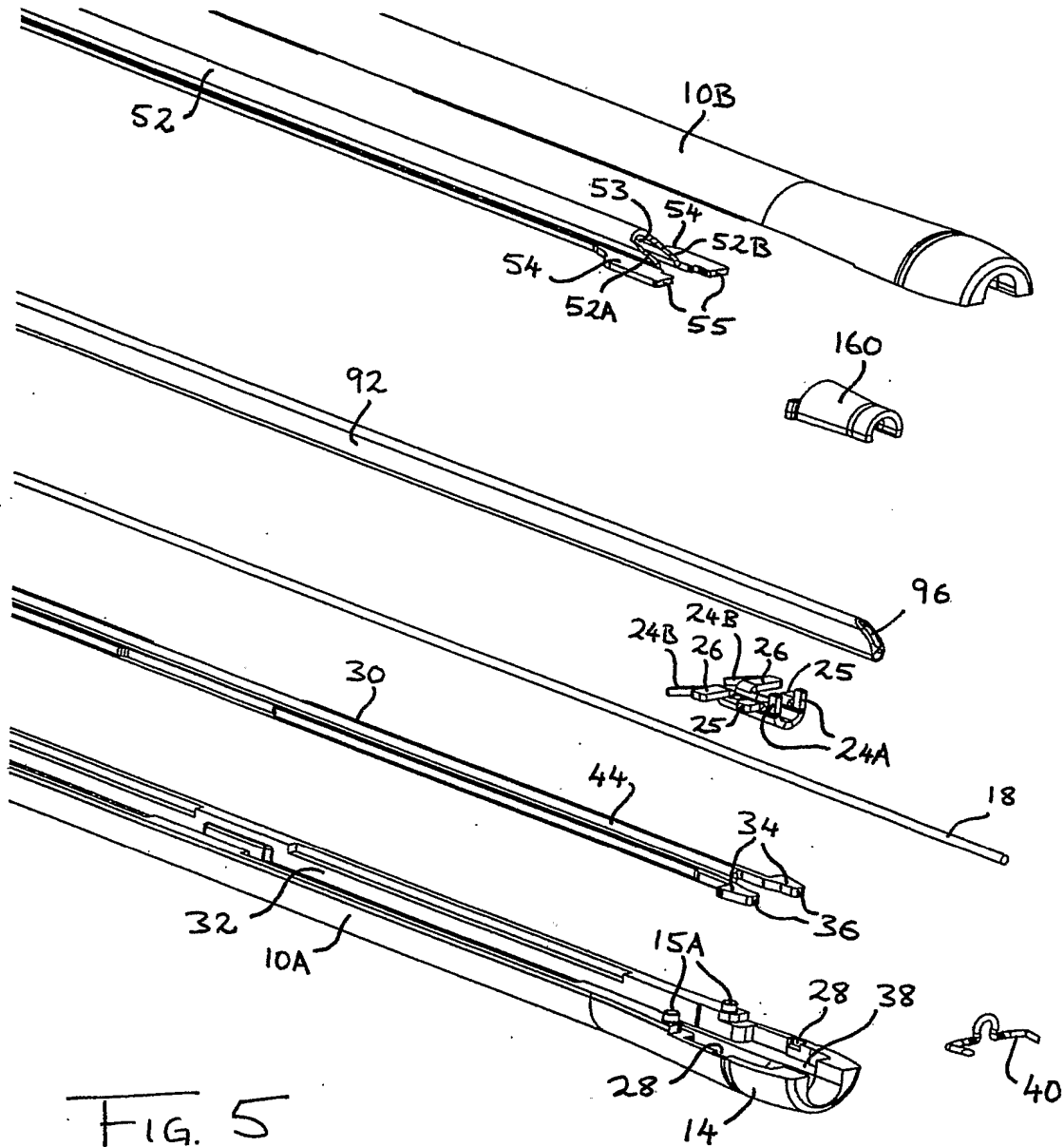

FIG. 5

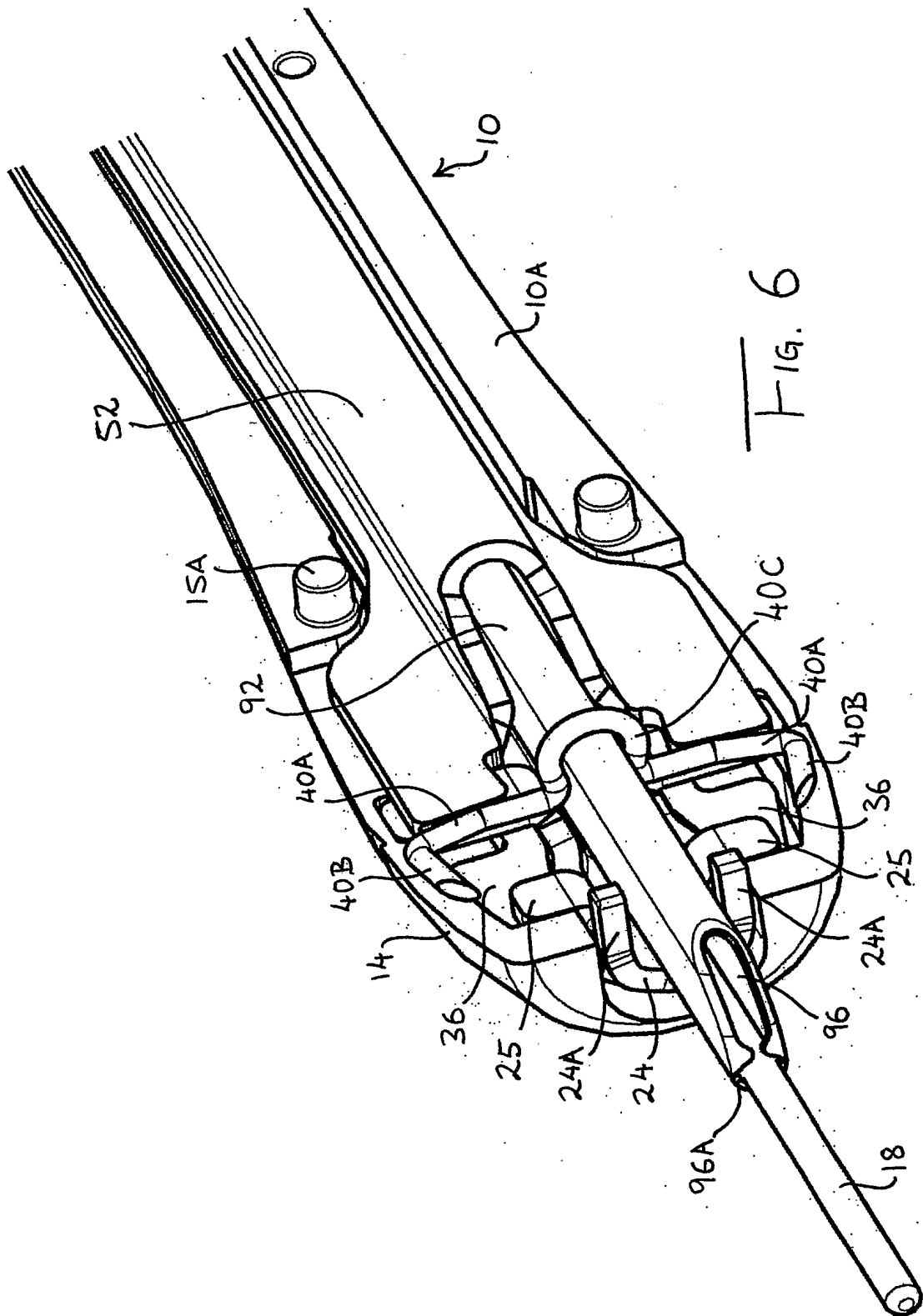

FIG. 6

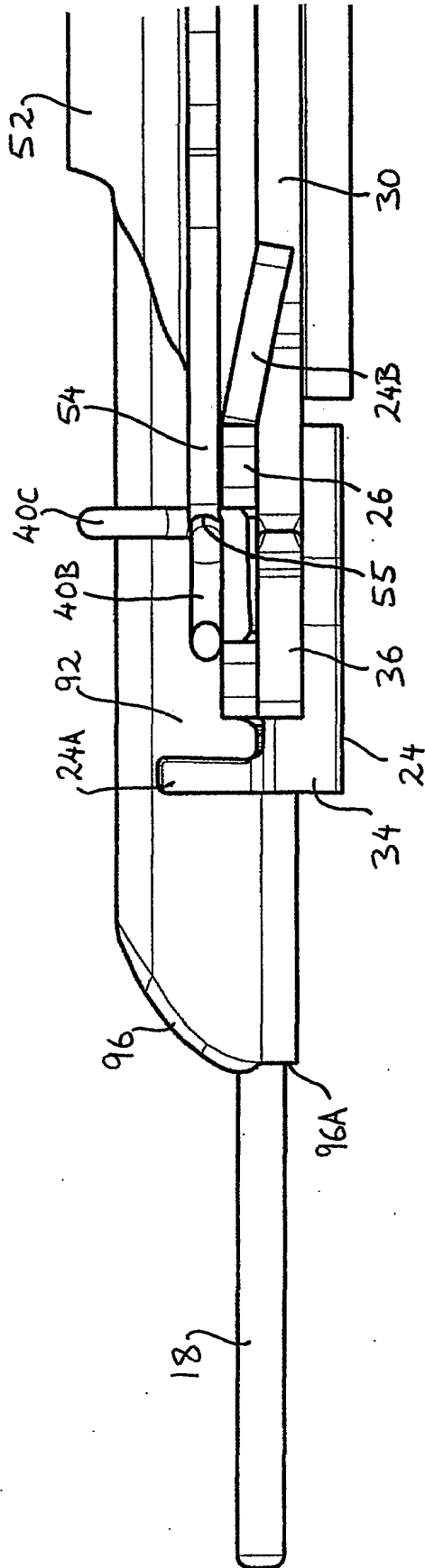
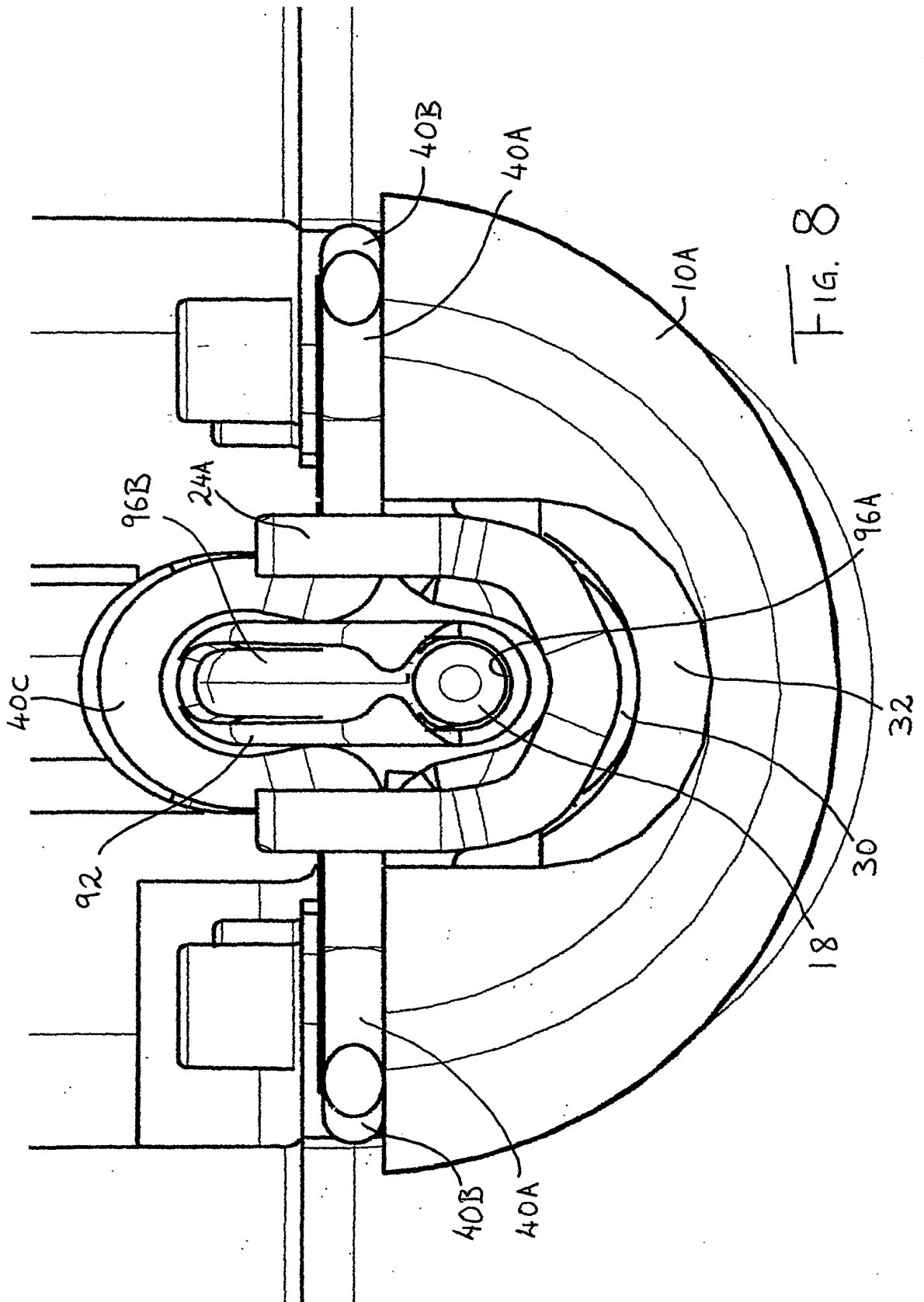
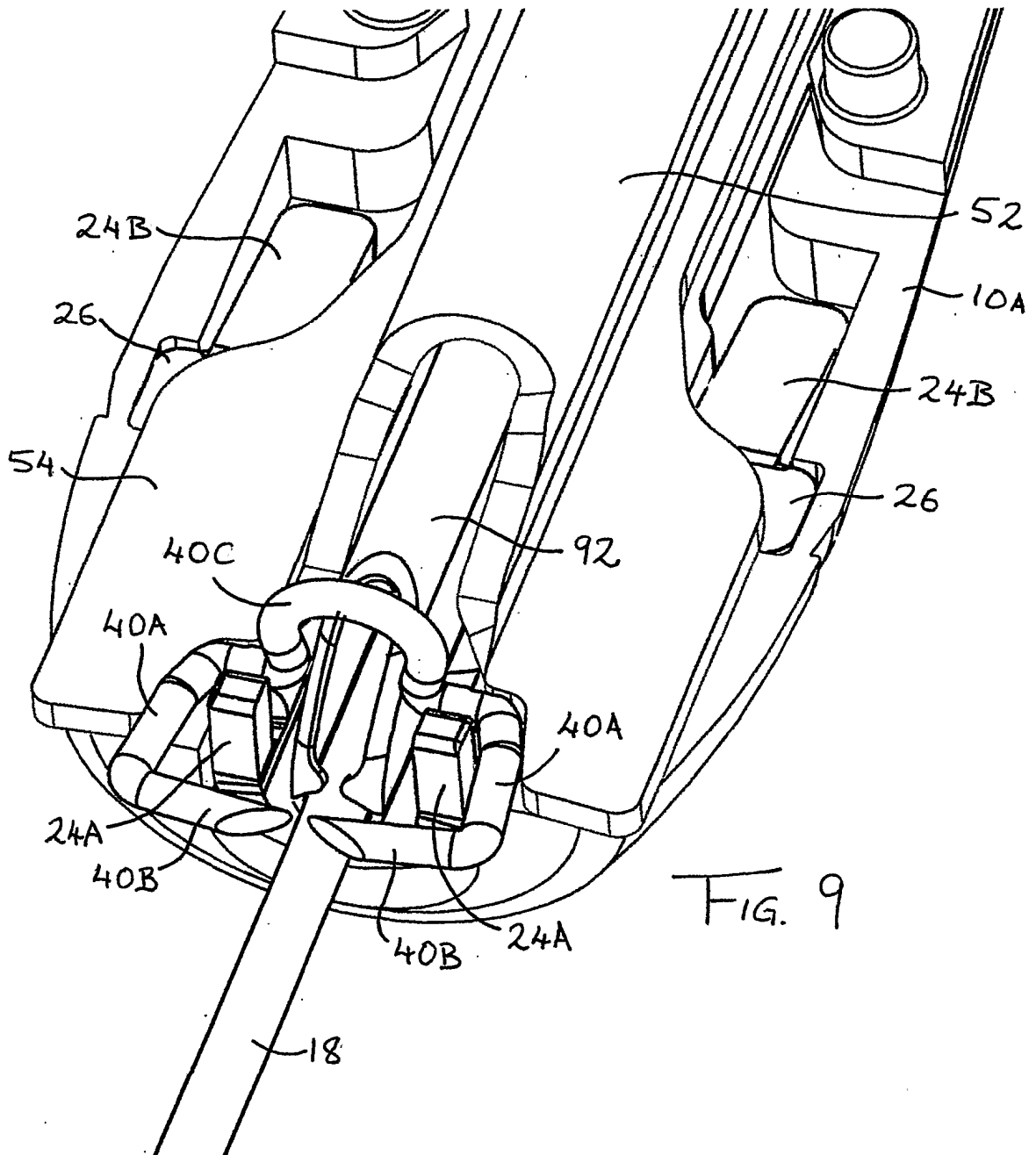

FIG. 7





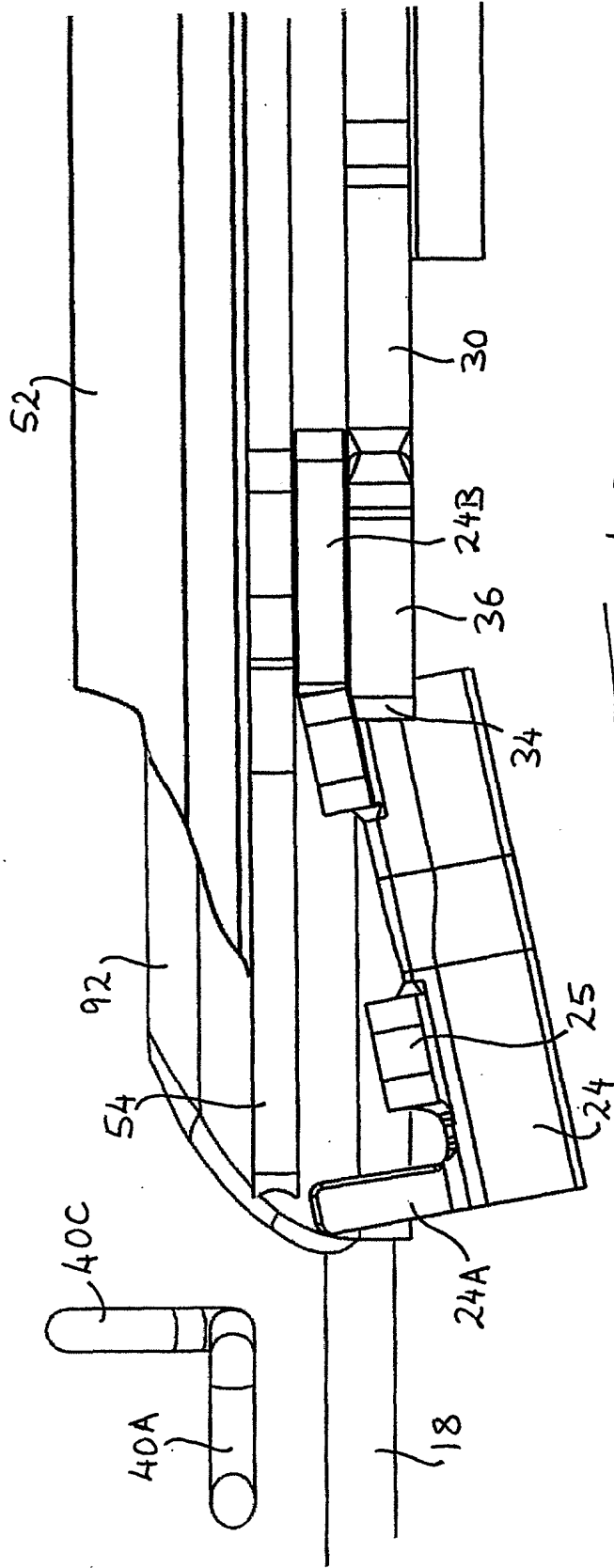

FIG. 10

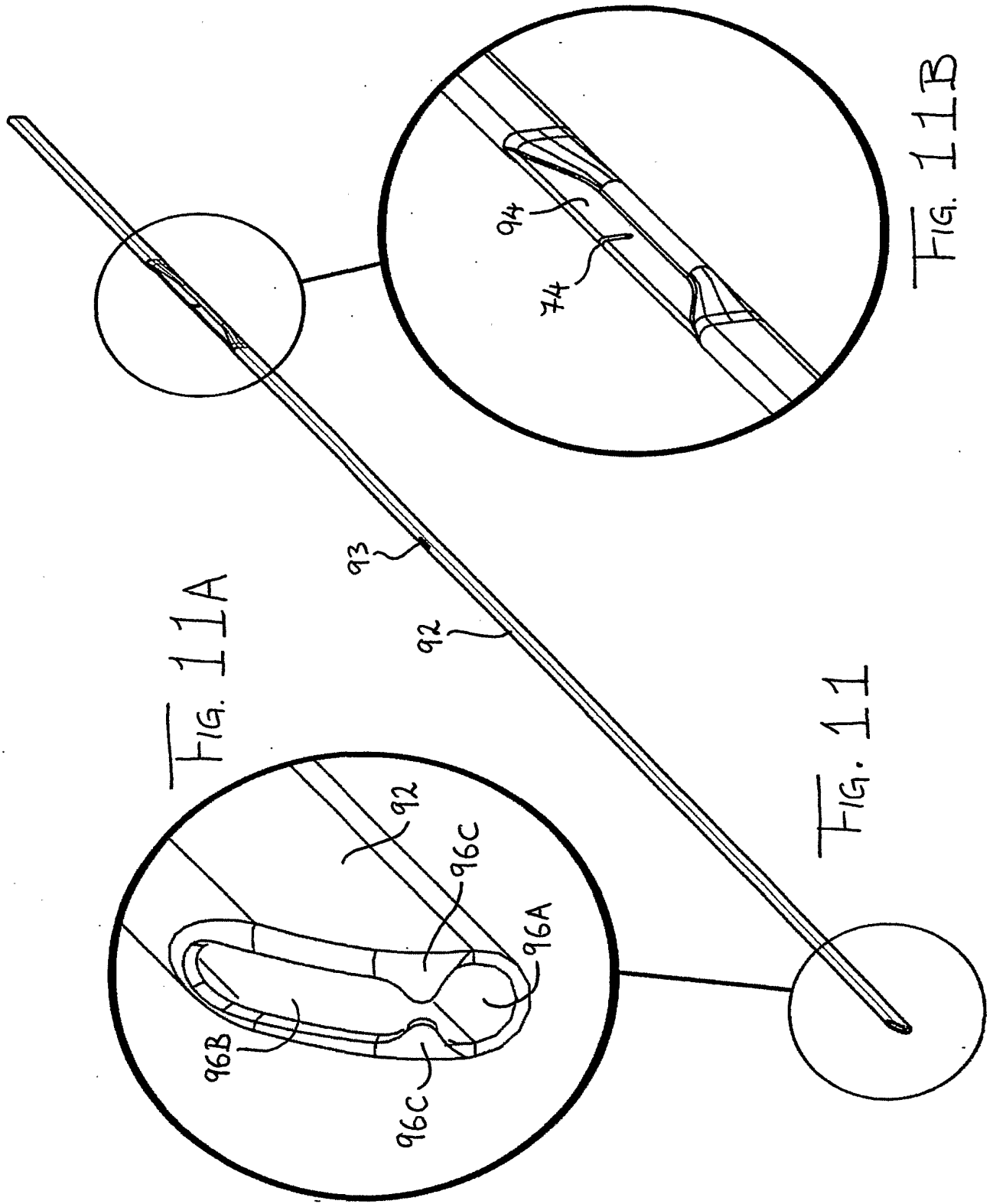

FIG. 11A

FIG. 11

FIG. 11B

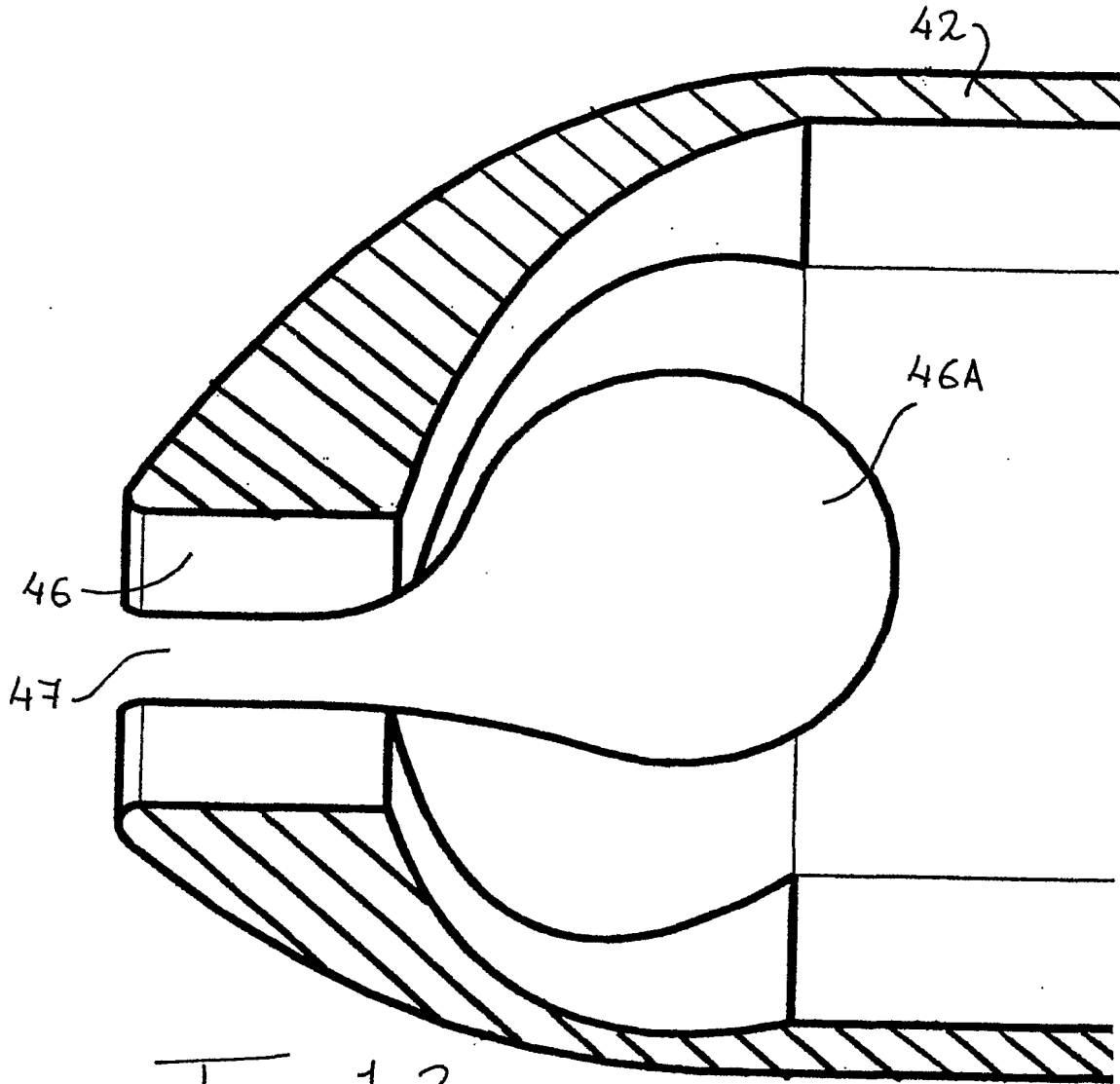

FIG. 12

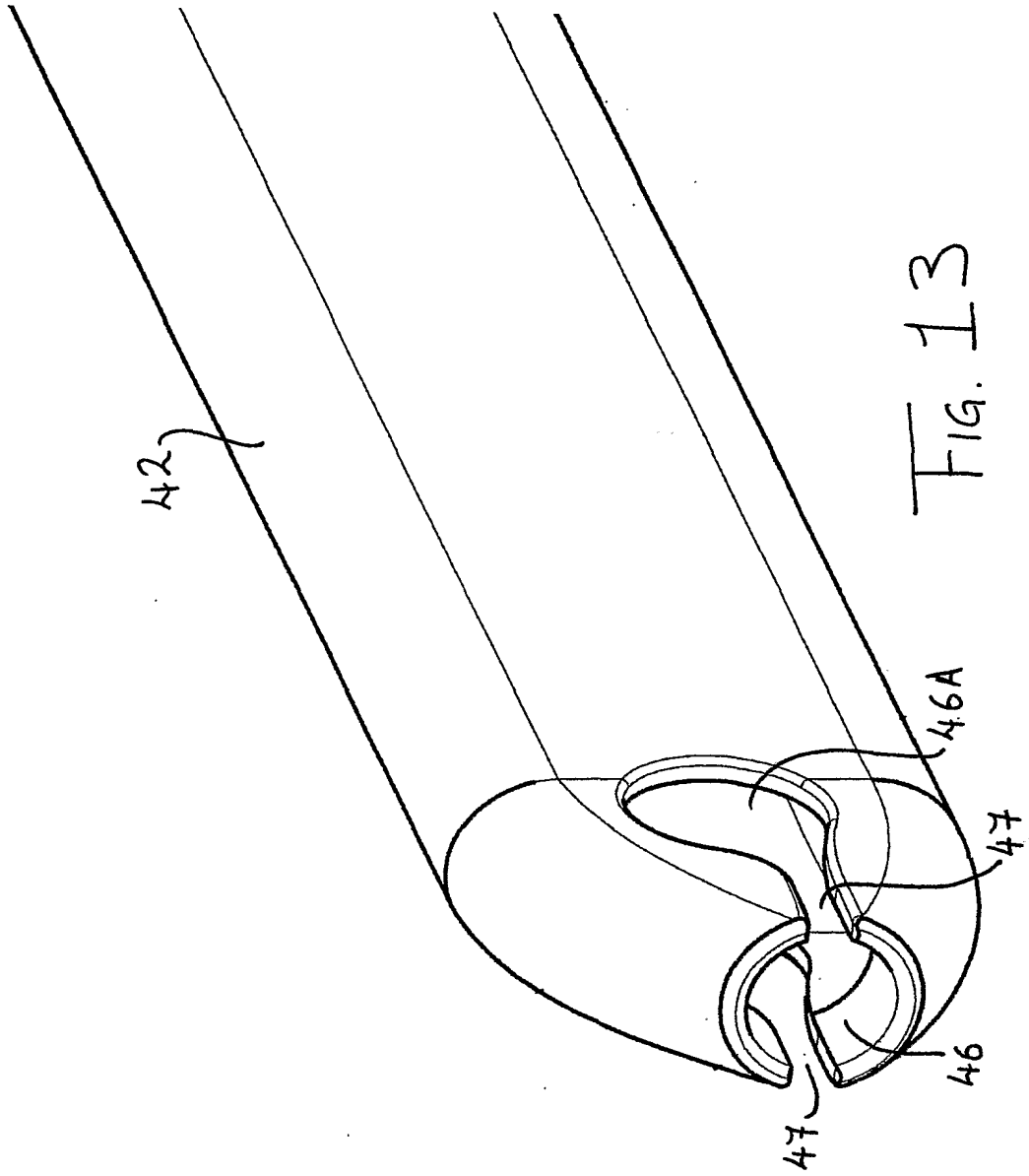
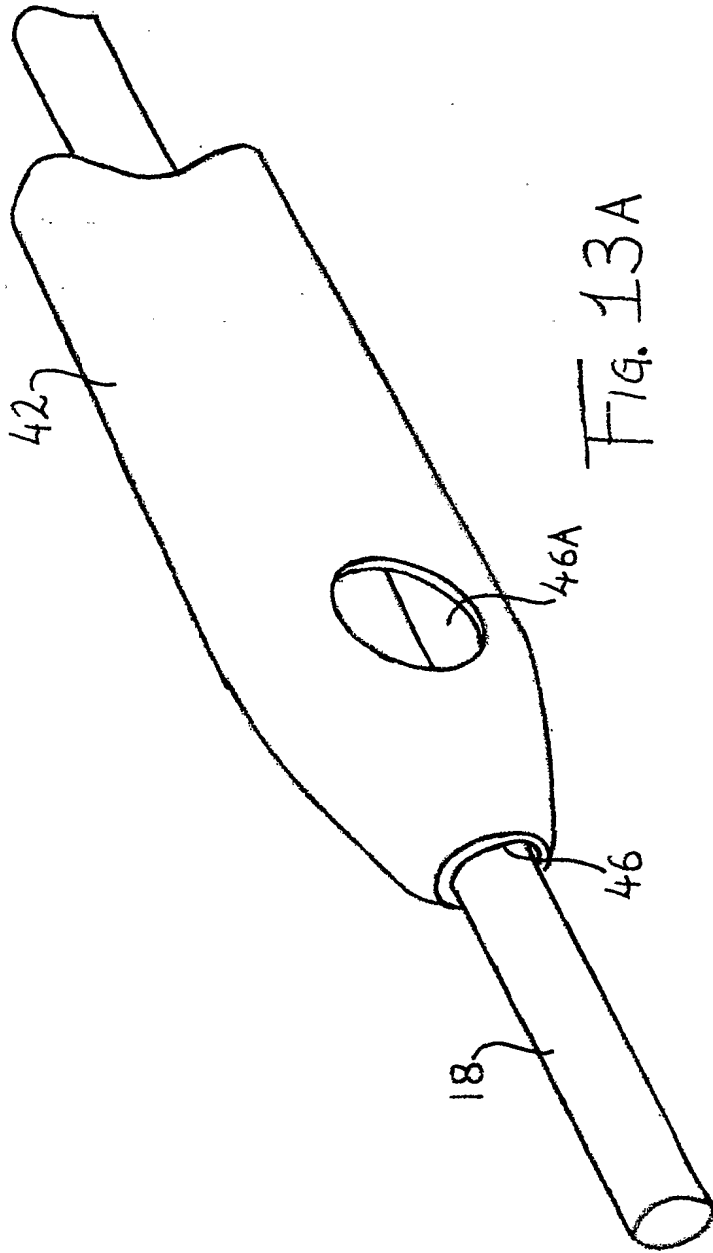

FIG. 13



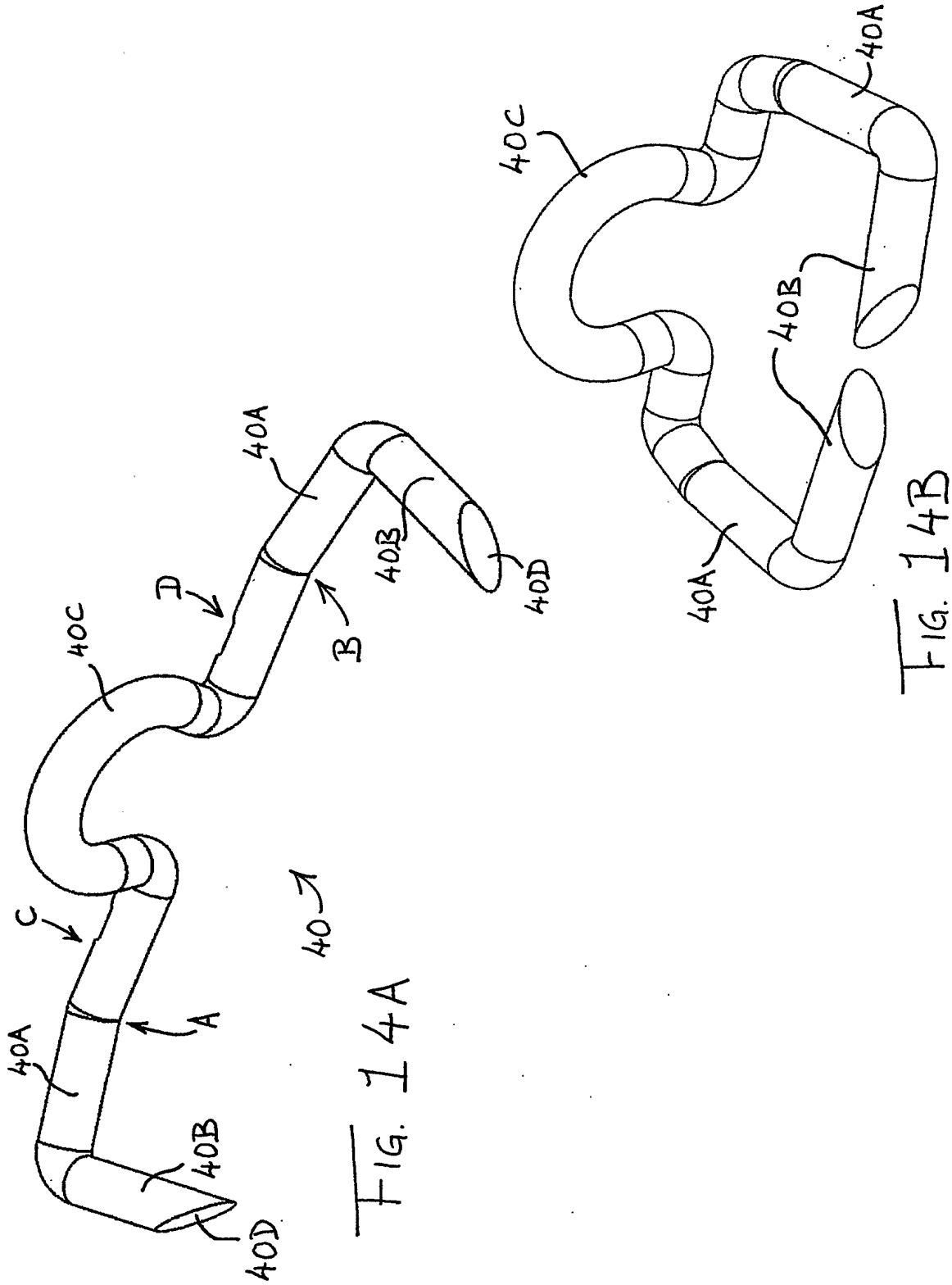
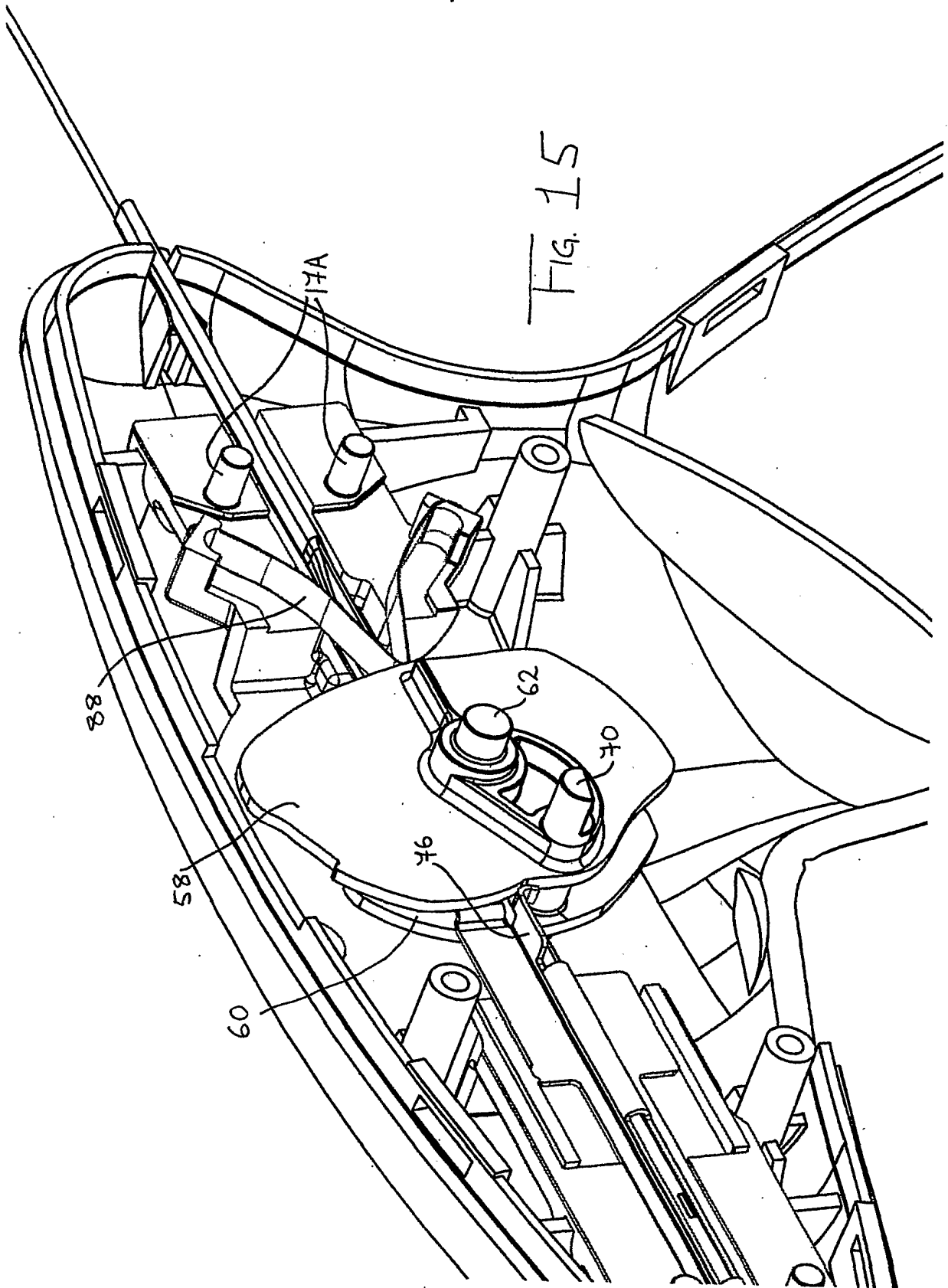

FIG. 14A

FIG. 14B



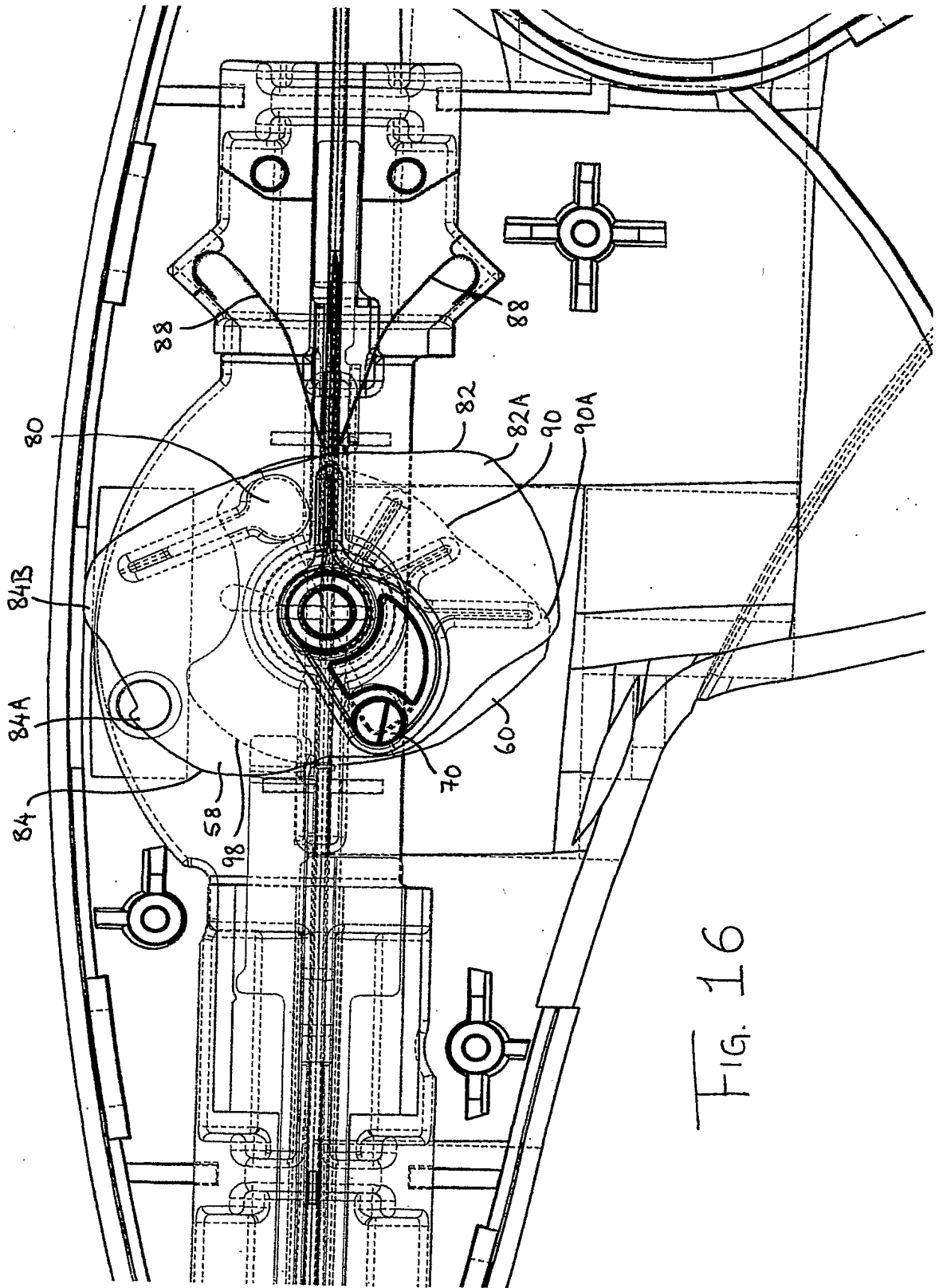

FIG. 16

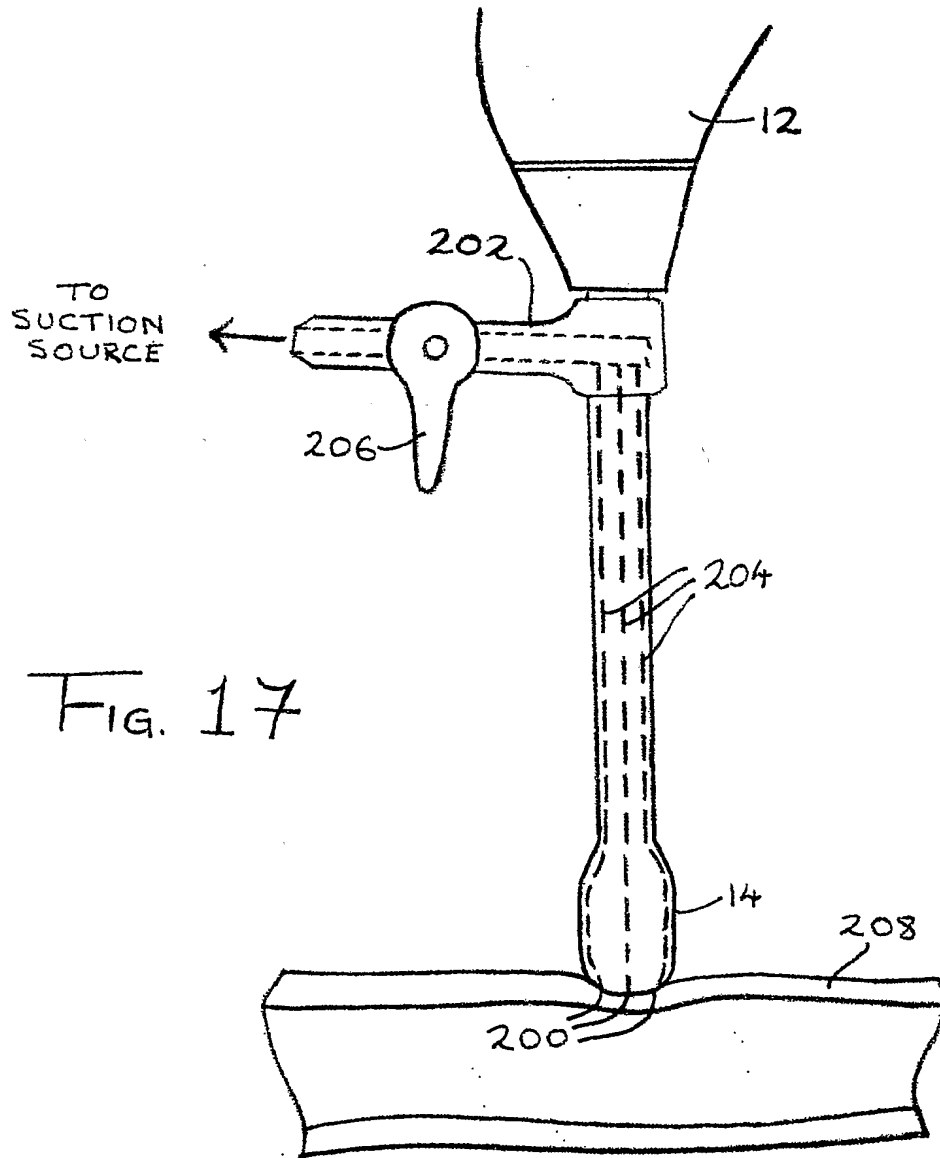

FIG. 17

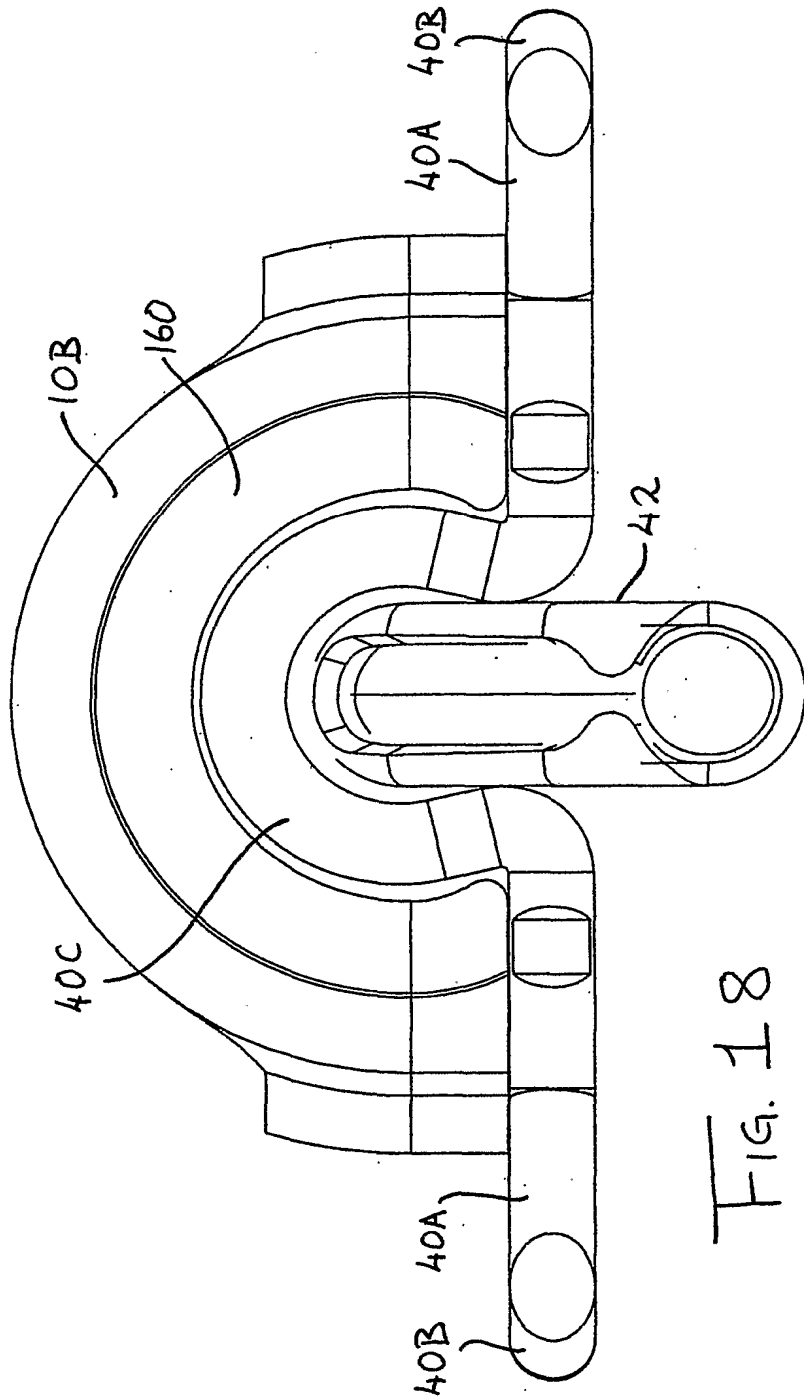

FIG. 18

INTERNATIONAL SEARCH REPORT

Int al Application No
PCT/IE 01/00115

A. CLASSIFICATION OF SUBJECT MATTER
IPC 7 A61B17/00 A61B17/068 A61B17/064

According to International Patent Classification (IPC) or to both national classification and IPC

B. FIELDS SEARCHED

Minimum documentation searched (classification system followed by classification symbols)
IPC 7 A61B

Documentation searched other than minimum documentation to the extent that such documents are included in the fields searched

Electronic data base consulted during the international search (name of data base and, where practical, search terms used)

EPO-Internal

C. DOCUMENTS CONSIDERED TO BE RELEVANT

Category °	Citation of document, with indication, where appropriate, of the relevant passages	Relevant to claim No.
X	US 5 292 309 A (THATCHER ROBERT J ET AL) 8 March 1994 (1994-03-08)	1, 2, 10
Y	the whole document ----	13
Y	WO 98 17179 A (GLEESON MALACHY ; TAYLOR JAMES (GB)) 30 April 1998 (1998-04-30)	13
A	abstract; figures 1-3 ----	1-12
X	US 5 643 318 A (TSUKERNIK VLADIMIR B ET AL) 1 July 1997 (1997-07-01)	1, 2
A	the whole document ----	13
X	US 5 431 639 A (SHAW WILLIAM J) 11 July 1995 (1995-07-11)	1, 2
A	abstract; figure 1 ----	13
	-/--	

Further documents are listed in the continuation of box C.

Patent family members are listed in annex.

° Special categories of cited documents :

- *A* document defining the general state of the art which is not considered to be of particular relevance
- *E* earlier document but published on or after the international filing date
- *L* document which may throw doubts on priority claim(s) or which is cited to establish the publication date of another citation or other special reason (as specified)
- *O* document referring to an oral disclosure, use, exhibition or other means
- *P* document published prior to the international filing date but later than the priority date claimed

- *T* later document published after the international filing date or priority date and not in conflict with the application but cited to understand the principle or theory underlying the invention
- *X* document of particular relevance; the claimed invention cannot be considered novel or cannot be considered to involve an inventive step when the document is taken alone
- *Y* document of particular relevance; the claimed invention cannot be considered to involve an inventive step when the document is combined with one or more other such documents, such combination being obvious to a person skilled in the art.
- *&* document member of the same patent family

Date of the actual completion of the international search

15 November 2001

Date of mailing of the international search report

26/11/2001

Name and mailing address of the ISA

European Patent Office, P.B. 5818 Patentlaan 2
NL - 2280 HV Rijswijk
Tel. (+31-70) 340-2040, Tx. 31 651 epo nl,
Fax: (+31-70) 340-3016

Authorized officer

Hansen, S

INTERNATIONAL SEARCH REPORT

Int'l Application No
PCT/IE 01/00115

C.(Continuation) DOCUMENTS CONSIDERED TO BE RELEVANT

Category *	Citation of document, with indication, where appropriate, of the relevant passages	Relevant to claim No.
A	US 5 861 005 A (KONTOS STAVROS B) 19 January 1999 (1999-01-19) the whole document ---	1-13
A	EP 0 941 697 A (TRICARDIA L L C) 15 September 1999 (1999-09-15) abstract; figure 1 -----	1-13

INTERNATIONAL SEARCH REPORT

...ormation on patent family members

Int: | Application No

PCT/IE 01/00115

Patent document cited in search report		Publication date	Patent family member(s)	Publication date
US 5292309	A	08-03-1994	AT 170387 T	15-09-1998
			AU 673224 B2	31-10-1996
			AU 5683794 A	15-08-1994
			CA 2152061 A1	04-08-1994
			DE 69320834 D1	08-10-1998
			DE 69320834 T2	21-01-1999
			DK 681460 T3	08-02-1999
			EP 0681460 A1	15-11-1995
			ES 2120000 T3	16-10-1998
			JP 2661799 B2	08-10-1997
			JP 8500518 T	23-01-1996
			WO 9416637 A1	04-08-1994

WO 9817179	A	30-04-1998	GB 2318295 A	22-04-1998
			AU 4711697 A	15-05-1998
			DE 69704714 D1	07-06-2001
			EP 0942685 A1	22-09-1999
			WO 9817179 A1	30-04-1998
			JP 2001502218 T	20-02-2001

US 5643318	A	01-07-1997	WO 9526683 A1	12-10-1995

US 5431639	A	11-07-1995	EP 0713402 A1	29-05-1996
			JP 9504444 T	06-05-1997
			WO 9505206 A2	23-02-1995

US 5861005	A	19-01-1999	US 6022372 A	08-02-2000

EP 0941697	A	15-09-1999	NO 980902 A	03-09-1999
			US 5728132 A	17-03-1998
			EP 0941697 A1	15-09-1999
